

Schedule										
* Single astrix indicates surgery required.										
** Double astrix indicates tree removal.										
To be read in conjunction with the Arborist's Report.										
Tree No	Species	Age	Condition	Stem mm	Height m	Branch Spread N S E W	E B C Years	Category grading	Preliminary Management & Observations	
1	Spanish Chestnut	M	Fair	700	10	3 4 6 1	20-40	B1	*Trunk has strong lean to east due to competition from no 2, correctional surgery will rejuvenate this tree	
2	Ash	DM	Poor	350	14	4 4 6 2	-10	D	** In Decline and needs removal	
3	Ash	FM	Good	750	14	6 4 6 6	20-40	A1	N/A	
4	Chestnut	FM	Good	1000	14	5 8 7 7	20-40	A1	N/A	
5	Sycamore	M	Good	350	13	4 4 4 4	20-40	A2	N/A	
6	Sycamore	Y	Good	200	8	1 2 2 2	20-40	C	** Keep the ash no 7 in place of this tree	
7	Ash	Y	Good	170	8	1 3 2 2	20-40	B2	N/A	
8	Chestnut	SM	Good	300	6	3 4 3 4	40+	B2	** Twin Stem - Prune to help future tree development	
9	Acer Platanoides 'Crimson King'	Y	Good	350	8	2 1 3 3	20-40	B2	N/A. Red Leaved Garden Maple	
10	Sycamore	Y	Good	350	8	5 5 5 5	20-40	C	** Removal of this multi-stemmed cluster of Sycamores will facilitate development of trees no 8 & 11	
11	Oak	SM	Good	300	6	2 2 5 4	40+	B2	** Twin Trunked. Prune to correct shape	
12	Elm	SM	Fair	450	8	3 3 4 4	-10	C	** Short lived suckering bushy tree	
13	Elm	Y	Fair	250	4	1 2 1 1	-10	C	** Short lived suckering bushy tree	
Tree No	Species	Age	Condition	Stem mm	Height m	Branch Spread N S E W	E B C Years	Category grading	Preliminary Management & Observations	
14	Sycamore	Y	Good	320	5	3 3 4 3	20-40	B2	N/A	
15	Elm	Y	Fair	260	4	2 2 3 2	-10	C	**	
16	Elm	Y	Fair	280	8	2 2 3 2	-10	C	**	
17	Ash	Y	Good	260	7	2 2 3 2	20-40	B2	N/A	
18	Elm	Y	Fair	280	8	2 2 3 2	-10	C	**	
19	Elm	Y	Fair	300	8	3 0 3 3	-10	C	**	
20	Sycamore	Y	Good	300	7	3 4 3 3	20-40	B2	N/A	
21	Sycamore	Y	Good	320	7	3 4 3 3	20-40	B2	N/A	
22	Beech	EM	Fair	650	8	6 6 6 6	40+	C	** A wide spreading tree from the base.	
23	Oak	SM	Good	350	6	4 4 4 4	40+	B	** A wide spreading tree from the base. Prune to shape tree	
24	Oak	SM	Good	300	6	3 3 3 3	40+	B	** A young developing oak. Can be transplanted elsewhere on site or pruned to shape.	
25	Atlantic Cedar	SM	Good	350	8	4 4 3 3	40+	B	N/A. Young ornamental conifer	
26	Monkey Puzzle	Y	Good	180	5	1 2 2 2	40+	B	N/A. Young ornamental conifer	
27	London Plane	Y	Good	250	6.5	1 2 1 1	40+	B	N/A. Can be transplanted elsewhere if desired.	
Tree No	Species	Age	Condition	Stem mm	Height m	Branch Spread N S E W	E B C Years	Category grading	Preliminary Management & Observations	
28	Sycamore	SM	Good	450	7	4 4 4 4	40+	B	N/A	
29	Red Oak	SM	Good	450	8.5	5 5 5 5	40+	B	** Red oak with large radiating branches. Prune to shape	
30	Sycamore	DM	Poor	700	13	4 3 4 4	-10	D	** In Decline. Numerous visible defects from base upwards.	
31	Elm	FM	Good	700	13	6 6 6 6	20-40	A1	N/A. Twin Trunk	
32	Sycamore	Y	Good	300	-7	3 3 3 3	40+	C	** The site has many of these seedling sycamores	
33	Grassfinch							C	** Common Garden Hedge	
34	Green Privet							C	** Common garden Hedge	

Legend	
	SITE BOUNDARY
	EXISTING TREES (Retained)
	EXISTING TREES (Removed)
	EXISTING TREES (Exact location not confirmed as of yet)
	EXISTING STONE BOUNDARY WALL

Conditions of use of this drawing
 note: if this A1 size drawing is reproduced at a smaller size which makes these conditions difficult to read, please contact the Architects office for a legible copy of these conditions.

- This drawing the design and contents contained herein are copyright. All rights are reserved. No part hereof may be copied or reproduced partially or wholly in any form whatsoever without the prior written consent of Simon J Kelly Architects.
- This drawing is to be relied upon only for the specific purpose and for the specific purpose for which it has been prepared. This drawing is not to be relied upon for construction purposes, and no implied or expressed warranty is given as to the suitability for construction purposes, unless the purpose of this drawing is stated to be "construction" or "contract". If the purpose is stated to be "contract" this drawing is not to be used for construction if it is also marked "preliminary".
- The Employer is granted a copyright licence to use this drawing and its contents for the purpose for which the drawing has been prepared. If this drawing has been prepared for construction purposes the licence will only be valid for a single constructed reproduction and shall expire once a single reproduction has occurred. Any such licence only passes to the Employer on payment of Architects fees in full and in any event the licence cannot be assigned without prior written consent of Simon J Kelly Architects.
- Where the Architects conditions of engagement provide that the Employer obtains copyright (whether by transfer of ownership or expressed or implied licence) for use on projects other than the project which the copyright material was specifically prepared for, the Architect does not accept any liability whatsoever howsoever arising for use of this drawing and its contents (in whole or in part) in relation to any project and/or purpose other than that for which it was specifically prepared. A copyright statement to use this drawing and its contents (in whole or in part) is not a warranty that use of this drawing and its contents (in whole or in part) is appropriate in circumstances other than the purpose and project for which it has been prepared.
- Do not scale off this drawing. Figure metric dimensions only should be taken off this drawing. Imperial dimensions, if any, contained on this drawing are given for illustrative purposes only.
- All contractors, whether main or sub contractors, must visit the site and are responsible for taking and checking any and all dimensions levels and the like that relate to the works.
- Where this drawing contains discrepancies in relation to other relevant documents, such discrepancies shall be brought to the attention of the Architects who shall issue a written instruction as to which information is to be followed, and until such written Architects instruction has been issued any work carried out on foot of the discrepancies shall be unauthorised.
- Reference to "Architect" or "Architects", whether to individual (S), British (BS) or otherwise, or codes of practice (CP) shall be deemed to refer to the relevant standard or code current at the date of issue of the drawing notwithstanding any reference to the contrary or to any earlier standard.
- Any reference to the "Architect" or "Architects" on this or any other relevant document shall mean the nominated project Architect and/or a Director of Simon J Kelly Architects who has been nominated as the partner-in-charge but only while such Architect remains in the employment of Simon J Kelly Architects.
- Any questions as to the meaning or application of these conditions shall be submitted in writing to the Architect for his/her ruling and such a ruling shall be conclusive as to the meaning or application of these conditions.
- Simon J Kelly Architects, their Agents, Architects, employees and/or directors shall not be liable for any loss damage or injury consequential or otherwise howsoever arising for failure to comply with any or all of these conditions.
- Should anyone copy this drawing in whole or in part with or without consent and use the copy in relation to a purpose and/or project for which the drawing has not been prepared for, such use is at the sole and exclusive risk of the copier and Simon J Kelly Architects do not accept any liability whatsoever howsoever arising in relation to such use.
- Should anyone copy this drawing in whole or in part with or without consent they should also copy these conditions of use in full and reproduce them with the copy. These conditions of use are to be read in conjunction with the drawing and its contents, these conditions of use form part of the drawing and its content and are inseparable from the drawing and its content.
- The use of or reliance upon this drawing and/or its contents shall be deemed to be acceptance of these conditions of use unless otherwise agreed in writing, such written agreement to be sought from and issued by the Architects prior to the use or reliance upon this drawing and/or its contents.
- All drawings are to be read in conjunction with the fire safety compliance report, all other contract documents, all statutory consents and/or requirements and all statutory obligations.

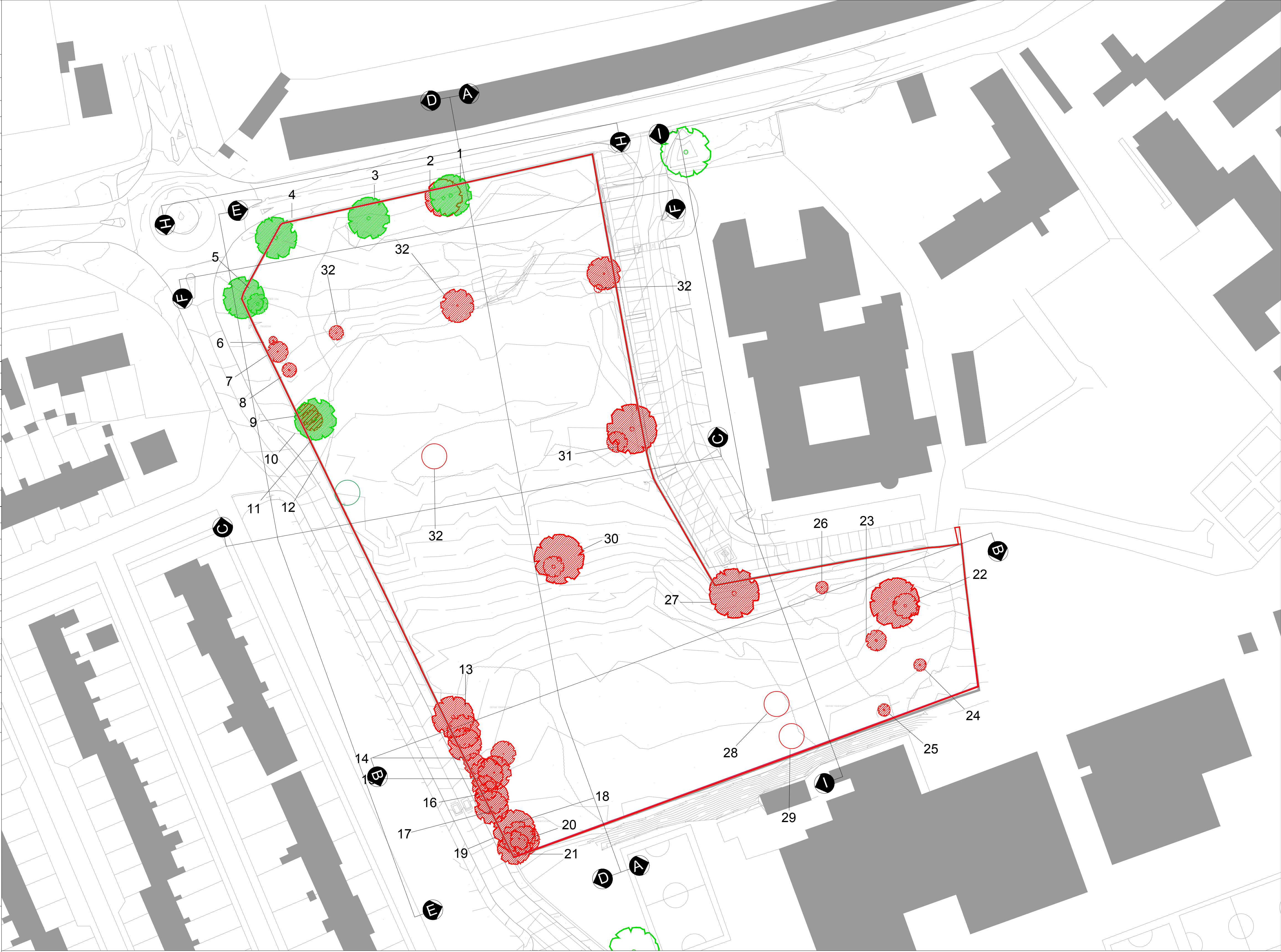

Tree Survey Plan

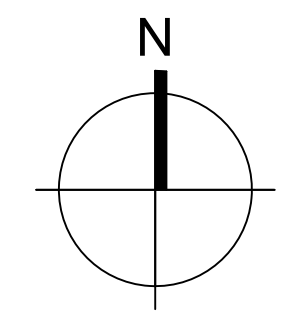

For planning purposes only