

Section 38 - Road Traffic Act, 1994

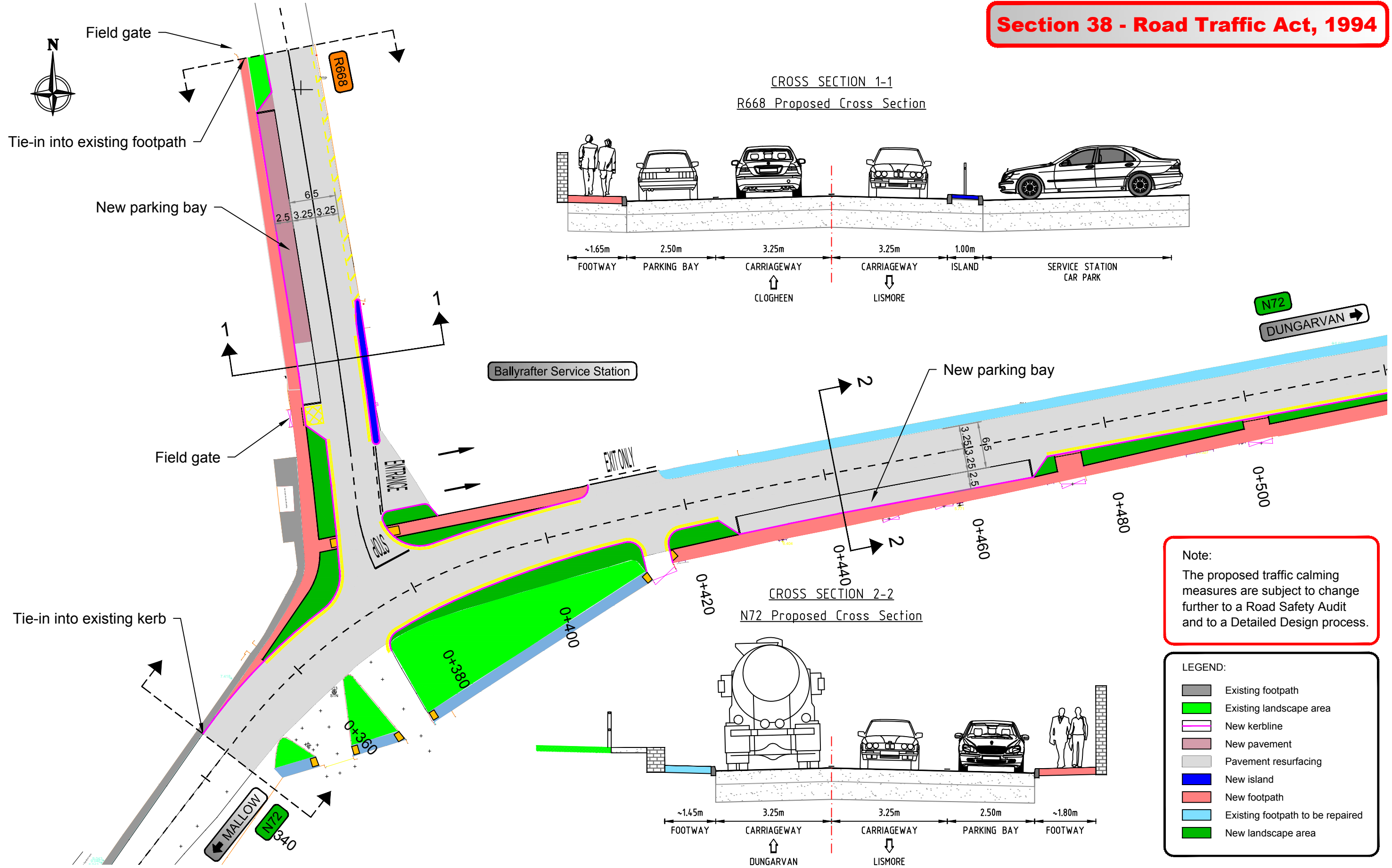

CROSS SECTION 1-1
R668 Proposed Cross Section

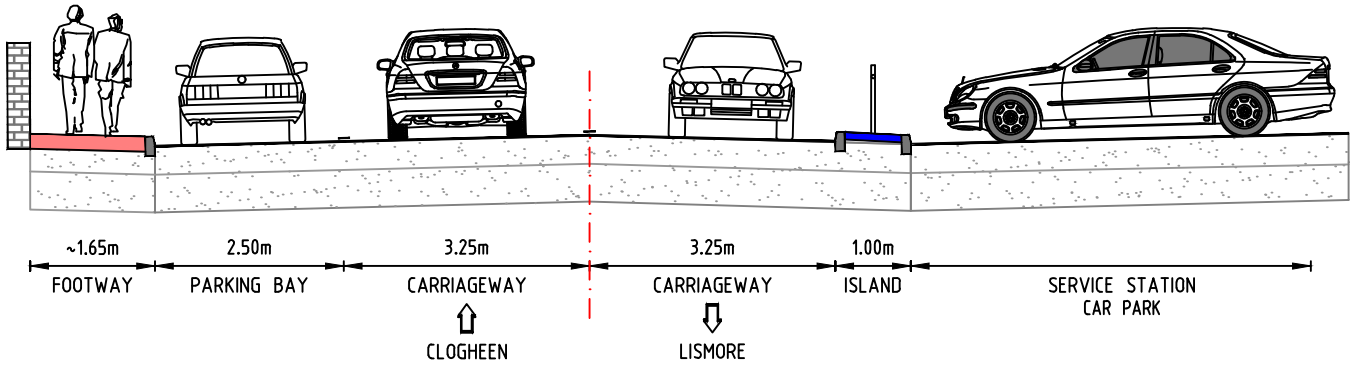

CROSS SECTION 2-2
N72 Proposed Cross Section

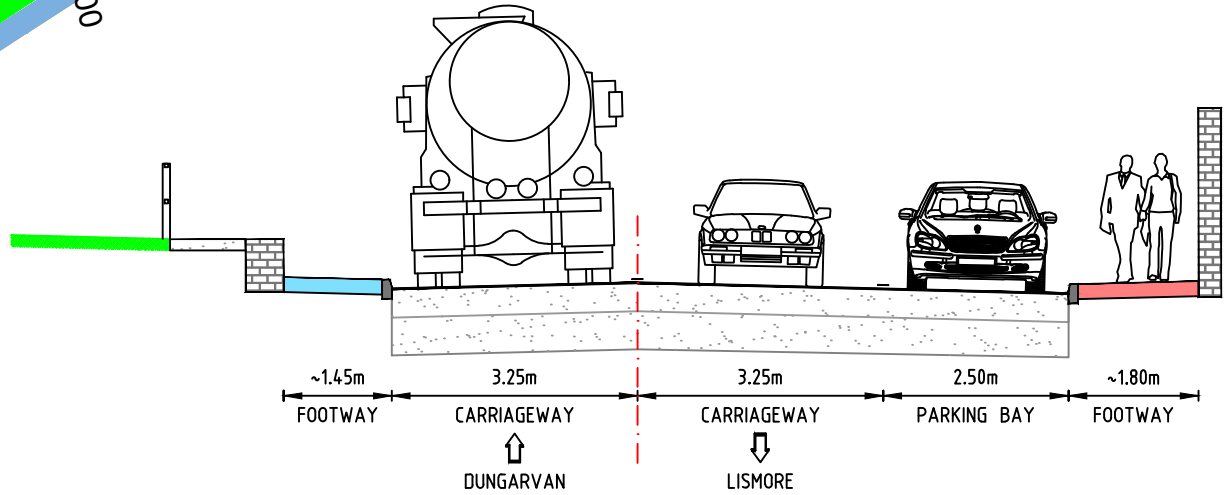

Note:
The proposed traffic calming measures are subject to change further to a Road Safety Audit and to a Detailed Design process.

LEGEND:

- Existing footpath
- Existing landscape area
- New kerbline
- New pavement
- Pavement resurfacing
- New island
- New footpath
- Existing footpath to be repaired
- New landscape area

NOTES:

DO NOT SCALE

| Revision | Date | Description | Drawn by | Checked by | Approved by |
|----------|------------|--|----------|------------|-------------|
| R1 | 20/02/2019 | Drawing issued for Section 38 - Road Traffic Act, 1994 | BE | JON | GH |

Client: **TII** (Transport Infrastructure Ireland)

Design: **Comhairle Cathrach & Contae Phort Láirge** (Waterford City & County Council)

Tel: 0761 102020
E-mail: contact@waterfordcouncil.ie

Approved by: G. Hynes (GH)
Checked by: J. O'Neill (JON)
Drawn by: B. Erak (BE)

Scale: 1:500 (@A3)
Rev. Date: 20/02/2019

Project Title: N72 Lismore - HD15 Site N72WD_141.1

Drawing Title: Proposed Layout

Drawing Number: MRG-4/17/003-DWG-103

TII Project No.: W/18/17641
MRG Project No.: MRG-4/17/003
Project Folder No.: 02
Rev.: R1

Unauthorised reproduction infringes Ordnance Survey Ireland and Government of Ireland copyright.