

WATERFORD CITY & COUNTY COUNCIL

COUNCIL MEETING 11th MARCH, 2021

PROPERTY MANAGEMENT

DISPOSAL:

D730

Disposal of approx 700.8m² at Durrow, Stradbally, Co. Waterford to Dean McGillicuddy.

Transfer in Fee Simple for the sum of €1,000 (one thousand euro). Purchaser to bear both sides costs.

(Ref. No. 1422)

D753

Disposal of 135m² & Wayleave/ROW of 85m² at Gleann Doire, Tramore, Co. Waterford to Geraldine Curran.

Transfer in Fee Simple for the sum of €15,000 (Fifteen thousand euro). Purchaser to bear both sides costs.

(Ref. No. 1423)

L857

Lease of 2.33 acres at Lafcadio Hearn Japanese Gardens, Tramore House, Tramore, Co. Waterford to Trustees of Lafacadio Hearn Japanese Gardens. Lease term of 25 years with rent of €1.00 (One euro) if demanded. Each side to bear own costs.

(Ref. No. 1424)

L713

Increase in lease area to 7.84 acres at Waterford Crystal FC playing pitches, Kilbarry, Waterford to Waterford & District Junior League. Existing Lease dated December 2019 terms to remain the same. Council to bear both sides costs. This S183 is in addition to S183 dated 17th July, 2020 Ref. 1390.

(Ref. No. 1425)

NOTICE UNDER SECTION 183, LOCAL GOVERNMENT ACT 2001

REFERENCE NO. 1422

TO: EACH MEMBER OF WATERFORD CITY AND COUNTY COUNCIL

Pursuant to the provisions of Section 183 of the Local Government Act, 2001, I give you notice of the proposed disposal of the properties described hereunder to the persons named and subject to the specified terms and conditions.

Heading	Description
Reference Number:	1422
File:	D730
Disposal Type:	Disposal
Townland:	Durrow
Address / Location:	Approx 700.8msq at Durrow, Stradbally, Co. Waterford. From Folio WD37512F Plan No. 1
Acquired From:	NA
Proposed to Dispose to:	Dean McGillicuddy, Durrow, Stradbally, Co. Waterford.
Terms & Conditions:	Transfer in Fee Simple for €1,000 (one thousand euro). Purchaser to bear both sides costs.
Location Map:	See map on next page.
Background	Tidying up of Title as this plot is clearly inside the boundary of Mr. McGillicuddy's land and has been in long term possession of previous owners of property also.
Valuation:	No valuation sought. We view as title rectification.
Dated:	1 st March, 2021

598550.783

633648.181

633421.975

598363.700

NOTES

 Outline of Disposal Area
 From Folio WD37512F
 Plan No. 1
 Area = 700.8m²

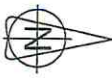

(c) Ordnance Survey Ireland. All rights reserved.
 Licence number 2016/18/CCH/WaterfordCity&CountyCouncil

REVISION	DATE	BY	CHKD



**Comhairle Cathrach
& Contae Phort Láirge**
 Waterford
 City & County Council

Kieran Kehoe
 DIRECTOR OF SERVICES
 CORPORATE CULTURE, HR & IS
PROPERTY MANAGEMENT
 ADDRESS : Level 3, Manoppa Building - The Mall, Waterford.
 TELEPHONE : 051 - 859741
 FAX NO. : 051 - 859708

PROJECT
 Disposal of 700.8m² of Land
 At Durrow, Stradbally,
 Co. Waterford.

TITLE
 Waterford City & County Council
 - WITH -
 Dean McGillicuddy

SCALE	JOB No.	ISSUE No.	DATE	ISSUE No.	DATE
1/1000	D730	001	10/09/2020	59972-C	
ON/AS/SH/ET					

NOTICE UNDER SECTION 183, LOCAL GOVERNMENT ACT 2001

REFERENCE NO. 1423

TO: EACH MEMBER OF WATERFORD CITY AND COUNTY COUNCIL

Pursuant to the provisions of Section 183 of the Local Government Act, 2001, I give you notice of the proposed disposal of the properties described hereunder to the persons named and subject to the specified terms and conditions.

Heading	Description
Reference Number:	1423
File:	D753
Disposal Type:	Disposal & Wayleave/Right of Way
Townland:	Crobally Upper
Address / Location:	Disposal of 135msq & Wayleave/Right of Way of 85msq at Gleann Doire, Tramore, Co. Waterford. From Folio WD 24449F
Acquired From:	NA
Proposed to Dispose to:	Geraldine Curran, Glen Cottage, Glen Road, Tramore, Co. Waterford.
Terms & Conditions:	Transfer in Fee Simple for €15,000 (fifteen thousand euro). Purchaser to bear both sides costs.
Location Map:	See map on next page.
Background	This strip of land provides the key to unlock the development potential of the adjacent site, owned by Geraldine Curran, by allowing access to Gleann Doire estate. Her 3 grown children plan on building homes on the adjacent site. This strip has been the source of anti-social behavior and illegal dumping and there have been problems securing it over the years.
Valuation:	Valuation by REA O'Shea O'Toole began at €15,000
Dated:	1 st March, 2021

603032.753

658756.068

658644.992

602940.626

51
52
53
54
55
56

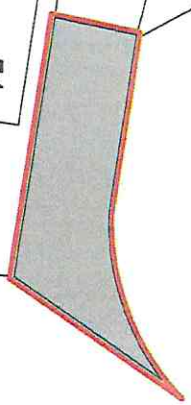

NOTES

Outline of Disposal area
135 m² from folio WD24449F

Outline of Mayleave area
85 m² on Folio WD24449F

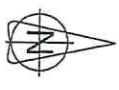

(c) Ordnance Survey Ireland. All rights reserved.
Licence number 2014/18/C/M/WaterfordCity&CountyCouncil

REVISION	DATE	INITIALS	NO.



Kieran Kehoe
DIRECTOR OF SERVICES
CORPORATE, CULTURE, HR & IS
PROPERTY MANAGEMENT
ADDRESS: Level 4, Keshna Building, The Mall, Waterford
TELEPHONE: 051-89741
FAX NO.: 051-84108

PROJECT
Disposal & Mayleave
At Gleann Doire, Tramore,
Co. Waterford

TITLE
Waterford City & County Council
- WITH -
Geraldine Curran

SCALE	1/500
JOB No.	D753
DATE	28/01/2021
DRAWING No.	001
DRAWN BY	JDoran
CHECKED BY	SS15-B

NOTICE UNDER SECTION 183, LOCAL GOVERNMENT ACT 2001

REFERENCE NO. 1424

TO: EACH MEMBER OF WATERFORD CITY AND COUNTY COUNCIL

Pursuant to the provisions of Section 183 of the Local Government Act, 2001, I give you notice of the proposed disposal of the properties described hereunder to the persons named and subject to the specified terms and conditions.

Heading	Description
Reference Number:	1424
File:	L857
Disposal Type:	Lease
Townland:	Tramore East
Address / Location:	Lease of 2.33 acres at Lafcadio Hearn, Japanese Gardens, Tramore House, Tramore, Co. Waterford.
Acquired From:	NA
Proposed to Dispose to:	Agnes Aylward, Chairperson Laura Cassin, Company Secretary Gary Graham, Director Honorary Patron of the Board: H.E. Paul Kavanagh, Ambassador of Ireland to Japan
Terms & Conditions:	Surrender of existing Lease/License Agreement with Tramore Development Trust expiring 1 st January 2033. Lease term of 25 years with rent at €1.00 if demanded. Each side to bear own legal costs.
Location Map:	See map on next page.
Background	Surrender of existing lease in the name of Tramore Development Trust to facilitate new lease in new company name of Lafcadio Hearn, Japanese Gardens.
Valuation:	None
Special Conditions:	Ensure access to Tramore House and agreements with tenant, NRA Staff, are respected and retained.
Dated:	1 st March, 2021

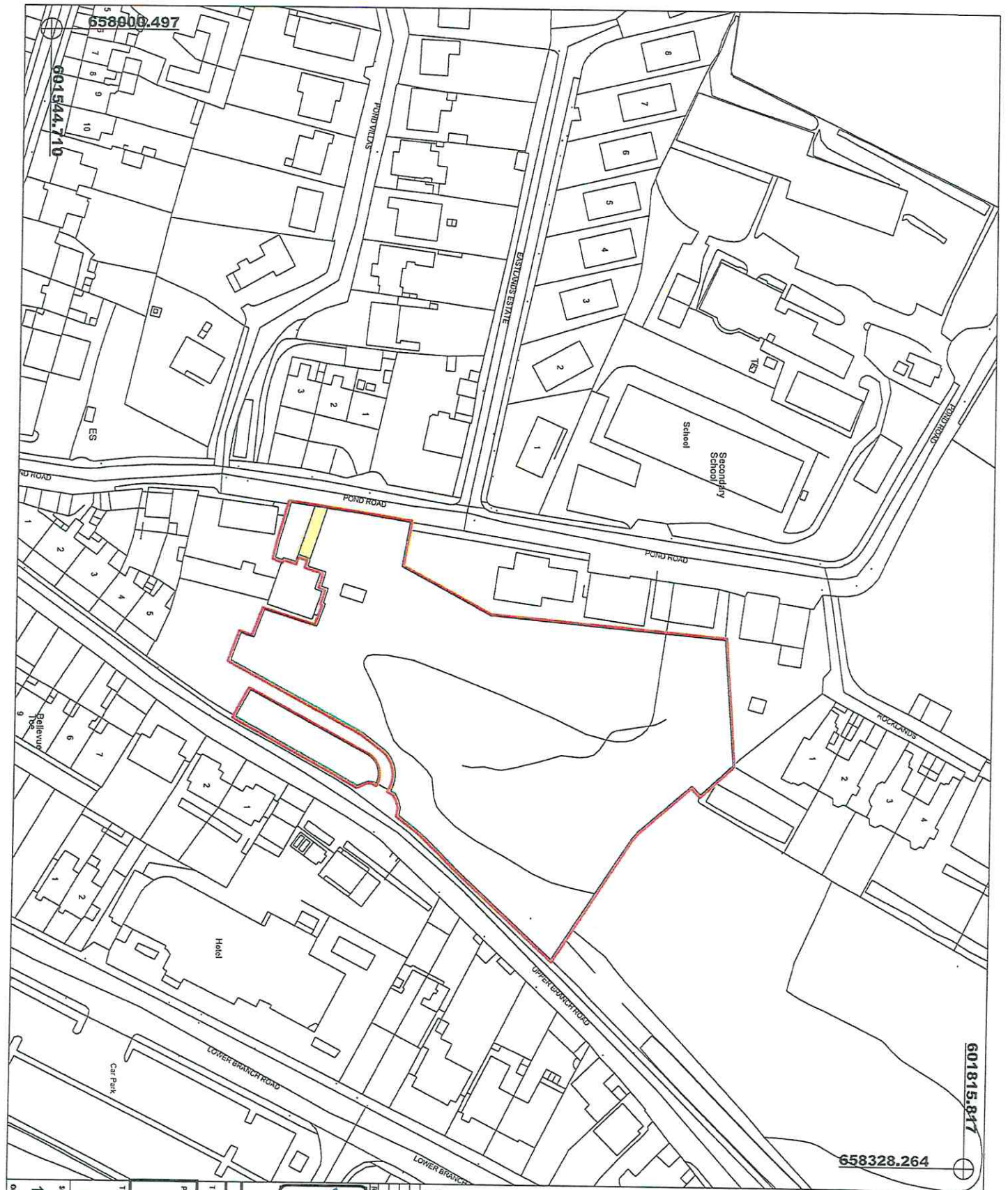

658900.497

601544.710

601815.847

658328.264

NOTES

-  Outline of Lease Area
Area = 2.33 Acres
-  Wayleave/Right of Way Area

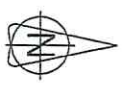

(c) Ordnance Survey Ireland. All rights reserved.
 Licence number 20030707CCH/Waterford City Council



**Comhairle Cathrach
& Contae Phort Láirge**
 Waterford
 City & County Council

KIERAN KEHOE
 DIRECTOR OF SERVICES
 CORPORATE, CULTURE, HR & IS
PROPERTY MANAGEMENT
 ADDRESS: Level 4, Johnson Building, The Mall, Waterford
 TELEPHONE: 051-499741
 FAX NO.: 051-494700

PROJECT
 Lease of 2.33 Acres of Gardens
 At Tramore House, Branch Road,
 Tramore, Co. Waterford.

TITLE
 Waterford City & County Council
 - WITH -
 Laidie Hean Japanese Gardens, Tramore

SCALE	1/1000
DATE	22/02/2021
JOB No.	1857
DRAWN BY	J Dornan
DATE	001
DRAWING No.	5772-B
ON A3 SHEET	

NOTICE UNDER SECTION 183, LOCAL GOVERNMENT ACT 2001

REFERENCE NO. 1425

TO: EACH MEMBER OF WATERFORD CITY AND COUNTY COUNCIL

Pursuant to the provisions of Section 183 of the Local Government Act, 2001, I give you notice of the proposed disposal of the properties described hereunder to the persons named and subject to the specified terms and conditions.

Heading	Description
Reference Number:	1425
File:	L713
Disposal Type:	Lease
Townland:	Kilbarry & Ballybeg
Address / Location:	Increase in Lease area to 7.84 acres at Waterford Crystal FC Playing Pitches (Kilbarry). All other terms remain the same.
Acquired From:	NA
Proposed to Dispose to:	Waterford & District Junior League
Terms & Conditions:	Existing Lease dated December 2019 to remain and side letter to cover increase in area to be added.
Location Map:	See map on next page.
Background	This Section 183 is in addition to S183 dated 17 th July, 2020 Ref: 1390.
Valuation:	None
Dated:	1 st March, 2021

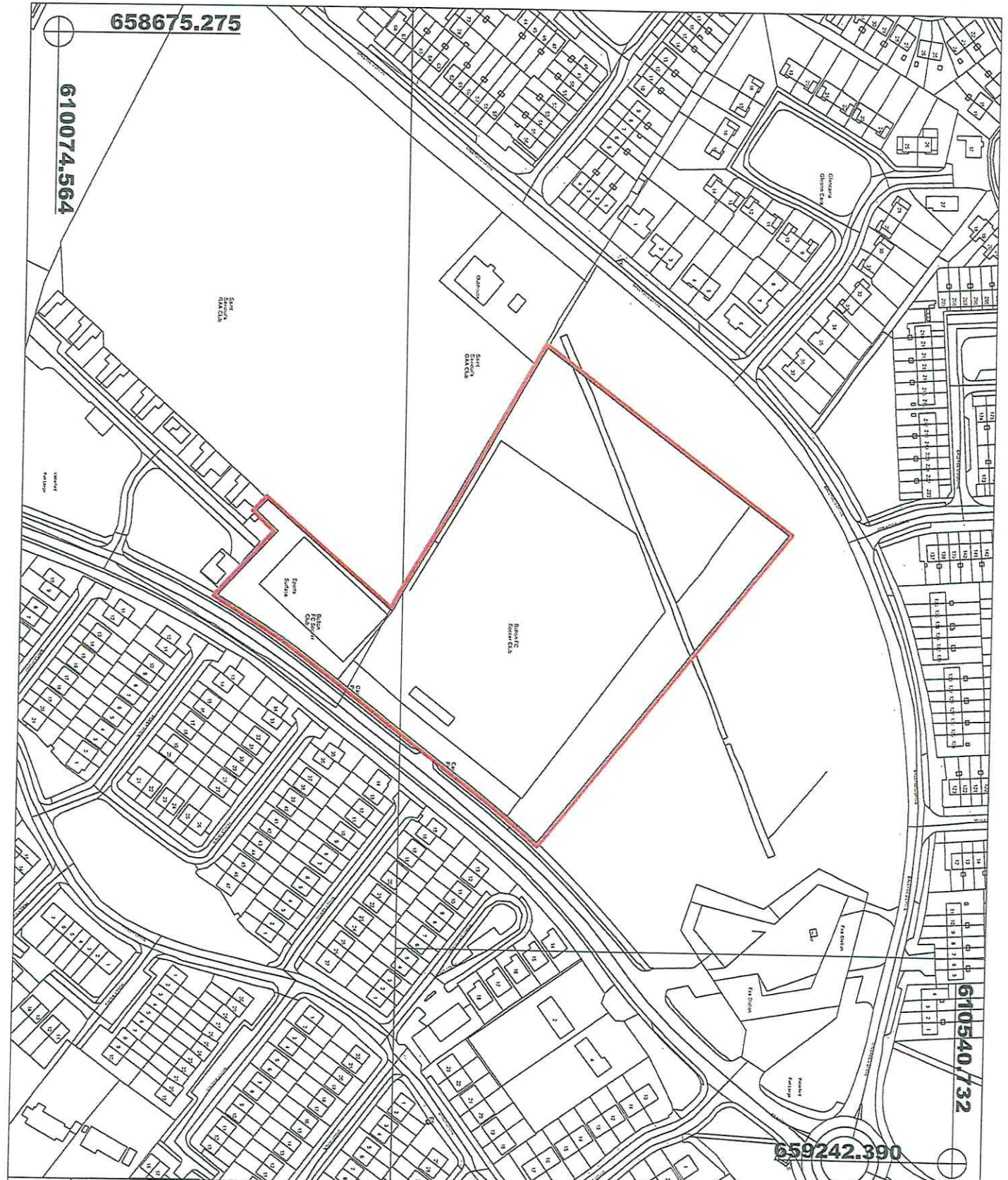

610540.732

659242.390

658675.275

610074.564

NOTES
 Outline of Lease Area
 Area = 31,727.4m² (7.84Acres)
 Folios WD12826 & WD11412

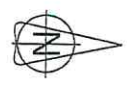

(c) Ordnance Survey Ireland. All rights reserved.
 Licence number: 2014/18/CMA/WaterfordCity&CountyCouncil

Comhairle Cathrach & Contae Phort Láirge
 Waterford City & County Council

Kieran Kehoe
 DIRECTOR OF SERVICES
 CORPORATE CULTURE, HR & IS
 PROPERTY MANAGEMENT

ADDRESS : Level 2, Kilmurry Building, The Park, Waterford.
 TELEPHONE : 051-849741
 FAX NO. : 051-841726

PROJECT
 Lease of 7.84 Acres of Land
 At Killybeg Road, Killybeg,
 Waterford.

TITLE
 Waterford City & County Council
 - WITH -
 Waterford & District Junior League

SCALE	1/2500
DATE	23/02/2021
JOB NO.	L 713
DRAWN BY	UDoran
CHECKED BY	UDoran
DATE	05.01.14/15
SCALE	001