



**Comhairle Cathrach  
& Contae Phort Láirge**  
Waterford City  
& County Council

**COIS TRÁ, DUNGARVAN**

**MOTORHOMES, MOTOR AND CAMPER VAN**

**PARKING BYE-LAWS 2021**



The Dungarvan/Lismore District Council (hereinafter referred to as “the Council”), in exercise of the powers conferred on it by Section 131A of the Local Government Acts 1925 to 2014 and pursuant to Section 36 of the Road Traffic Act, 1994, Section 101 (7) of the Road Traffic Act 1961 provided a car park known as Cois Trá, Dungarvan, in the County of Waterford, now hereby makes the following bye-laws:-

1. These Bye-Laws shall be cited as the “Cois Trá, Dungarvan Motorhomes, Motor and Camper Van Parking Bye-Laws 2021” and shall come into operation and apply to the Motor Caravan Parking Area as set out in the First Schedule to these bye-laws from the **11<sup>th</sup> day of May, 2021**.
2. In these Bye-Laws except where the context otherwise requires, words and phrases shall have any meanings assigned to them by Section 101 of the Road Traffic Act 1961 and the following words and phrases shall have the following meanings respectively:-

**"Bye-Laws"** means these Dungarvan Motorhomes, Motor and Camper Van Parking Bye-Laws 2021;

**"Council"** means Waterford City & County Council;

**"Agent of the Council"** means any person employed by Waterford City & County Council and any other person authorized by the Council to carry out functions under these bye-laws;

**"Display"** means to exhibit a document on a vehicle so that the document is prominently visible and legible from the exterior of the vehicle;

**"Motor Caravan"** includes Motor Homes, Motor Caravans and Camper Vans and has the same meaning as defined in EU/678/2011 as “a vehicle of category M with living accommodation space which contains the following equipment as a minimum” seats and table; sleeping accommodation which may be converted from the seats; cooking facilities; storage facilities; this equipment shall be rigidly fixed to the living compartment.

**"Motor Caravan Parking Area"** means the portion of the land comprised in the First Schedule to these bye-laws which is shown on the map attached to these bye-laws;

**"Motor Caravan Parking Bay"** means a parking space for the parking of one Motorhome, Motor and Camper Van in the Motor Caravan Parking Area , the area of which parking space is indicated by surface or other signs or markings;

**"Motor Caravan Pay Parking Ticket"** means a parking ticket which is issued by the Council by means of a pay and display parking ticket machine and which contains the following particulars:-



- a) the words Waterford City & County Council,
- b) the fee paid in respect of the ticket,
- c) the date and time and issue of the ticket,
- d) the time of expiry of the ticket,
- e) the location of issue of the ticket.

**"Valid Motor Caravan Pay Parking Ticket"** means a pay parking ticket which:-

- a) has been issued by a machine provided by the Council following the payment of the charge prescribed hereinafter,
- b) is not invalid due to the expiry of time and,
- c) is displayed upon a vehicle which has not been parked in the Motor Caravan Parking Area for more than 48 hours.

**"Pay and Display Parking Ticket Machine"** means a machine capable of automatically delivering a pay and display parking ticket when the appropriate fee prescribed by these bye-laws is inserted into the machine.

- 3. No vehicle other than a Motor Caravan shall be parked in the Motor Caravan Parking Area.
- 4. A Motor Caravan shall not be parked in the Motor Caravan Parking Area in such a manner that it occupies more than one Motor Caravan Parking Bay.
- 5. The maximum charge for a Motor Caravan Pay Parking Ticket shall be €10 for a period of 24 hours. The charge can be reduced at low season by Chief Executive Order, if required.
- 6. A Motor Caravan parked in a Motor Caravan Parking Bay shall display a valid Motor Caravan Pay Parking Ticket.
- 7. A Fixed Penalty Notice will be issued for non display of a valid Motor Caravan Pay Parking Ticket.
- 8. A Motor Caravan shall not be parked in the Motor Caravan Parking Area for a period in excess of 48 consecutive hours.
- 9. The following shall not be used in the Motor Caravan Parking Area:
  - (i) awnings,
  - (ii) tables,
  - (iii) chairs,
  - (iv) other camping equipment,
  - (v) built in generators,
  - (vi) free-standing generators.
- 10. Only vehicles that have paid the minimum fee shall be allowed to use the water and



sewerage services provided.

11. A prohibition on parking imposed in these bye-laws shall not apply to any of the following :-
  - a) a unit of the Fire Brigade, an Ambulance or an official vehicle being used by a member of the Garda Síochána in the performance of the duties of that member;
  - b) a vehicle being used by an employee of the Council in the performance of the duties of that person as an employee of the Council.





FIRST SCHEDULE - MAP SHOWING COIS TRÁ CAR PARK LOCATED IN DUNGARVAN, IN THE COUNTY OF WATERFORD SHOWING THE MOTOR CARAVAN PARKING AREA

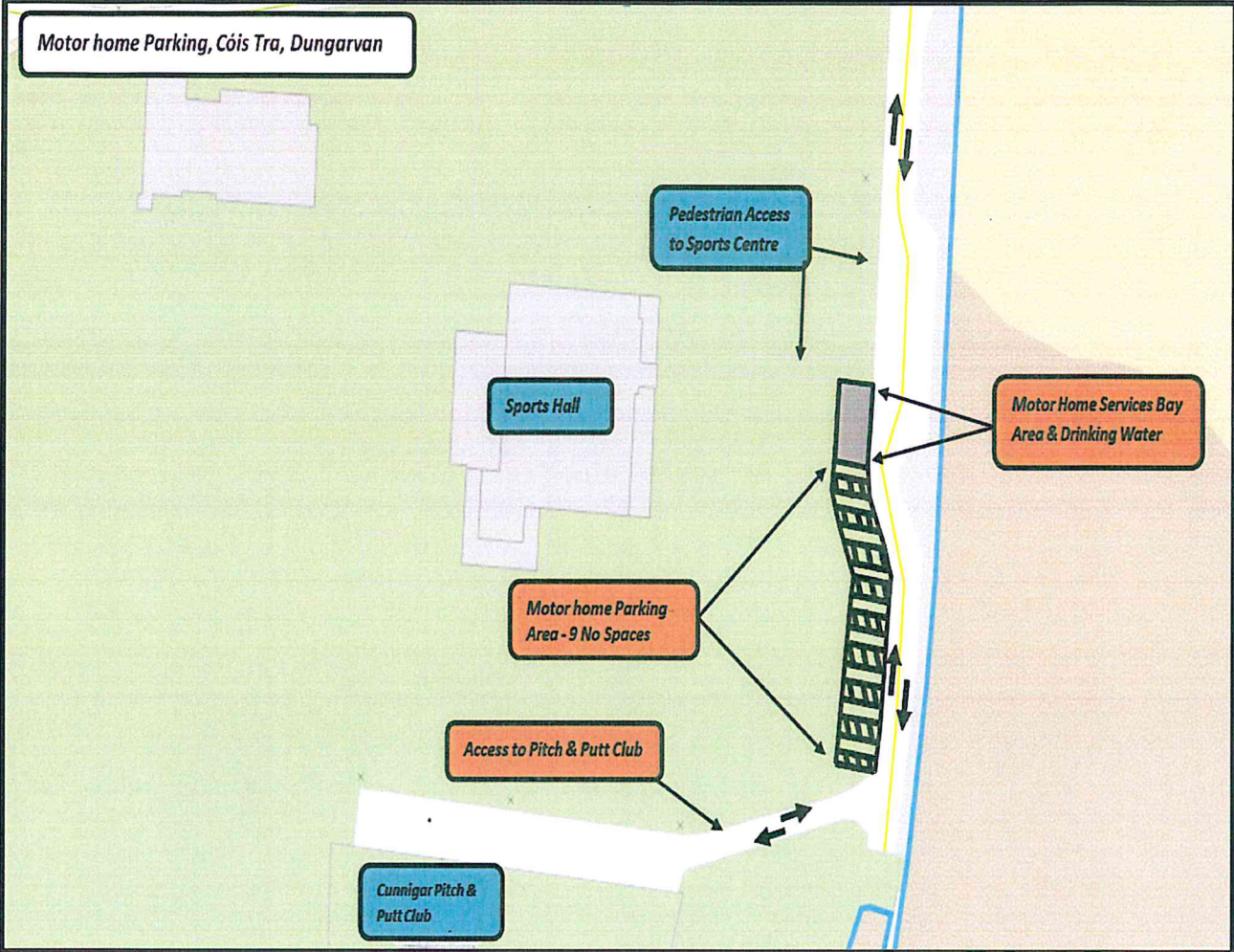



Made and adopted under the Common Seal of Waterford City and County Council

This 12th day of April, 2021.

Present when the seal of Waterford City & County Council was affixed hereto:



---

**Clr James Tobin**  
**Cathaoirleach of Dungarvan/Lismore District Council**



---

**Director of Services**  
**Roads, Water and Environment**



## **EXPLANATORY NOTE**

This note is not part of the Instrument and does not purport to be a legal interpretation. These bye-laws are made pursuant to Section 101(7) of the Road Traffic Act 1961 to use the car park provided by the Council at Cois Trá, Dungarvan for the purpose of restricting the classes of vehicles which may be admitted to it, to specify the charges to be made for the use of it, the periods for which vehicles may remain in it (including overnight parking) and to specify the conditions subject to which vehicles may use the car park.

