



NOTES

-  Outline of CPA Area
-  Denotes Land to be Compulsorily Acquired

WATERFORD CITY & COUNTY COUNCIL
COMPULSORY ACQUISITION 2024, (No.4)
Derelict Sites/Vacant Homes.

The official seal of the Local Authority was affixed hereto this

John day of *March* 2024.
Johnston Mayor
Shillan Chief Executive

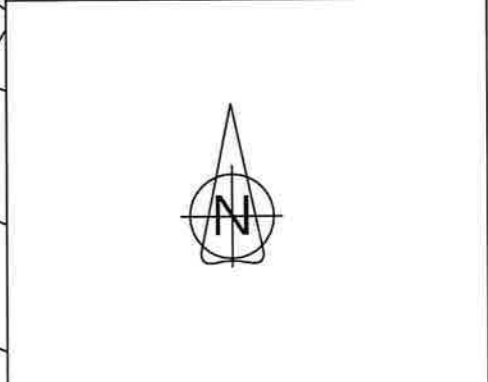

(c) Ordnance Survey Ireland. All rights reserved.
 Licence number 2014/18/CCMA/WaterfordCity&CountyCouncil

REVISION	DATE	INTLS	No.



Paul Johnston
 A/DIRECTOR OF SERVICES
 PLANNING, CORPORATE, CULTURE, HR & IS
PROPERTY MANAGEMENT
 ADDRESS : Level 4, Menapia Building, The Mall, Waterford.
 TELEPHONE : 0818 10 2020
 EMAIL : contact@waterfordcouncil.ie

PROJECT
 Compulsory Acquisition 2024-04
 Derelict Sites DS23073

TITLE
 Compulsory Acquisition at
 Shamrock Place, Tramore,
 Co. Waterford.

SCALE 1/500	JOB No. CPA 2024-04	DRAWING No. 001
DATE 13/03/2024	DRAWN BY M. Zelazny	O.S. REF. 5915-13

Schedule - Lands to be Compulsorily Acquired

Plot Ref. No. Deposited at the Offices of the Local Authority	Area		Townland	Electoral District Division	Description	Owners or reputed Owners	Lessees or Reputed Lessees	Occupiers
	Hectare	Acre						
101	0.0117	0.0291	Tramore East	Tramore-Waterford City West	Residential	Mars Capital, c/o Jonathan Fitzgerald	Unknown	None

ON A3 SHEET