

6055-14.670  
Plan - Northern Land

5773-D, 5845-B

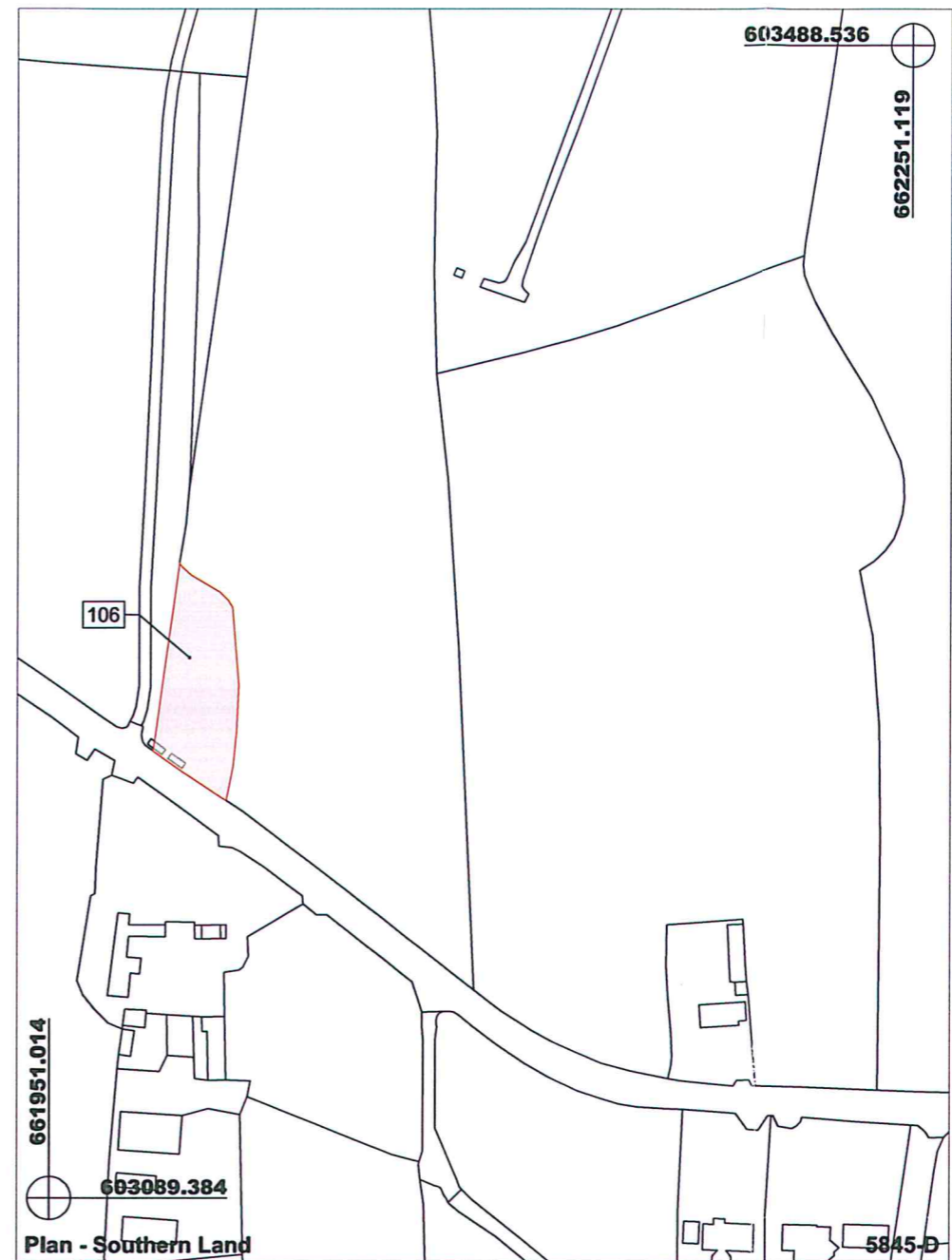

603089.384  
Plan - Southern Land

603488.536  
662251.119

606203.775  
663247.710

**Schedule Part II : Lands to be Compulsorily Acquired**

Plot Ref. No. Deposited at the Offices of the Local Authority	Area		Townland	Electoral District Division	Description	Owners or reputed Owners	Lessees or Reputed Lessees	Occupiers
	Hectare	Acre						
101	0.30920	0.764	Dallygarran	Waterford City East	Airfield Reserve Area/ Existing Residential	Frank Moran & Margaret Moran	Unknown	Frank Moran & Margaret Moran
102	0.35440	0.876	Dallygarran	Waterford City East	Airfield Reserve Area/ Existing Residential	John Elliot & Barbara Elliot	Unknown	John Elliot & Barbara Elliot
103A	0.00048	0.001	Keiloge	Waterford City East	Agricultural	Martin Gahan	Unknown	Martin Gahan
103B	0.00038	0.001	Keiloge	Waterford City East	Agricultural	Martin Gahan	Unknown	Martin Gahan
103C	0.00038	0.001	Keiloge	Waterford City East	Agricultural	Martin Gahan	Unknown	Martin Gahan
104A	0.00620	0.015	Keiloge	Waterford City East	Agricultural	Sean Pierce	Unknown	Sean Pierce
104B	0.00068	0.002	Keiloge	Waterford City East	Agricultural	Sean Pierce	Unknown	Sean Pierce
104C	0.00068	0.002	Keiloge	Waterford City East	Agricultural	Sean Pierce	Unknown	Sean Pierce
104D	0.00068	0.002	Keiloge	Waterford City East	Agricultural	Sean Pierce	Unknown	Sean Pierce
104E	0.00068	0.002	Keiloge	Waterford City East	Agricultural	Sean Pierce	Unknown	Sean Pierce
104F	0.00720	0.018	Keiloge	Waterford City East	Agricultural	Sean Pierce	Unknown	Sean Pierce
104G	0.00068	0.002	Keiloge	Waterford City East	Agricultural	Sean Pierce	Unknown	Sean Pierce
104H	0.00077	0.002	Keiloge	Waterford City East	Agricultural	Sean Pierce	Unknown	Sean Pierce
104I	0.00023	0.001	Keiloge	Waterford City East	Agricultural	Sean Pierce	Unknown	Sean Pierce
104J	0.00333	0.008	Keiloge	Waterford City East	Agricultural	Sean Pierce	Unknown	Sean Pierce
104K	0.00043	0.001	Keiloge	Waterford City East	Agricultural	Sean Pierce	Unknown	Sean Pierce
105A	0.00045	0.001	Monamintra	Waterford City East	Agricultural	Patrick Hearne	Unknown	Patrick Hearne
105B	0.00072	0.002	Monamintra	Waterford City East	Agricultural	Patrick Hearne	Unknown	Patrick Hearne
105C	0.00500	0.012	Monamintra	Waterford City East	Agricultural	Patrick Hearne	Unknown	Patrick Hearne
105D	0.00024	0.001	Monamintra	Waterford City East	Agricultural	Patrick Hearne	Unknown	Patrick Hearne
105E	0.00068	0.002	Monamintra	Waterford City East	Agricultural	Patrick Hearne	Unknown	Patrick Hearne
105F	0.00068	0.002	Monamintra	Waterford City East	Agricultural	Patrick Hearne	Unknown	Patrick Hearne
105G	0.00068	0.002	Monamintra	Waterford City East	Agricultural	Patrick Hearne	Unknown	Patrick Hearne
105H	0.00068	0.002	Monamintra	Waterford City East	Agricultural	Patrick Hearne	Unknown	Patrick Hearne
106	0.16827	0.416	Lisselan	Waterford City South	Airfield Reserve Area/ Existing Residential	Daniel Flynn	Unknown	Daniel Flynn

**NOTES**

Denotes Land to be Compulsorily Purchased

**WATERFORD CITY & COUNTY COUNCIL**  
Lands & Easements Adjacent to  
**Waterford Airport**  
**COMPULSORY PURCHASE ORDER**  
**NO.18 OF 2019**

The official seal of the Local Authority was affixed hereto this  
11<sup>th</sup> DECEMBER day of December 2019.  
John Brett Mayor  
Michael Chief Executive

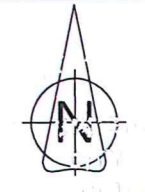

(c) Ordnance Survey Ireland. All rights reserved.  
Licence number 2014/18/CCMA/WaterfordCity&CountyCouncil

REVISION DATE INTLS No.



**Kieran Kehoe**  
DIRECTOR OF SERVICES  
CORPORATE, CULTURE, HR & IS

**PROPERTY MANAGEMENT**  
ADDRESS : Level 4, Menapia Building, The Mall, Waterford.  
TELEPHONE : 051 - 849741  
FAX NO. : 051 - 844708

PROJECT **Compulsory Purchase Order No. 18 of 2019**  
**Lands & Easements Adjacent to Waterford Airport**

TITLE **Compulsory Purchase Order Map Land Acquisition - Schedule II**

SCALE 1/2500	JOB No. CPO2019-18	DRAWING No. 001
DATE 10/12/2019	DRAWN BY JDoran	O.S. REF. 5773-D 5845-B/D

ON A3 SHEET