



**NOTES**

-  Outline of CPO Area
-  Denotes Land to be Compulsorily Purchased.

**WATERFORD CITY & COUNTY COUNCIL FOR MAIN STREET (NORTHSIDE), CAPPOQUIN, Co. WATERFORD**

**Vesting Order No.6 of 2023**

The official seal of the Local Authority was affixed hereto this *25<sup>th</sup>* day of September 2023.

*[Signature]* Mayor  
*[Signature]* Chief Executive

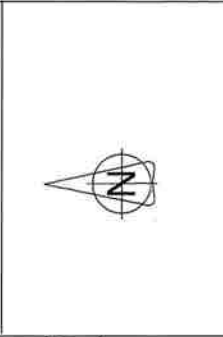

(c) Ordnance Survey Ireland. All rights reserved.  
 Licence number 2014/18CCMA/WaterfordCity&CountyCouncil

REVISION	DATE	INITIALS	NO.



**PROPERTY MANAGEMENT**

ADDRESS: Level 4, Menage Building, The Mall, Waterford.  
 TELEPHONE: 051-884741  
 FAX: 051-884708

**PROJECT**  
 Compulsory Purchase Order No. 13 of 2019  
 Main Street, Cappoquin, Co. Waterford

**TITLE**  
 Vesting Order No.6 2023  
 Main Street, Cappoquin, Co. Waterford

SCALE	JOB No.	DRAWING No.	DATE	ISSUED BY	DATE REC.
1:500	VO 2023-06	001	21/09/2023	V. O'Shea	59668

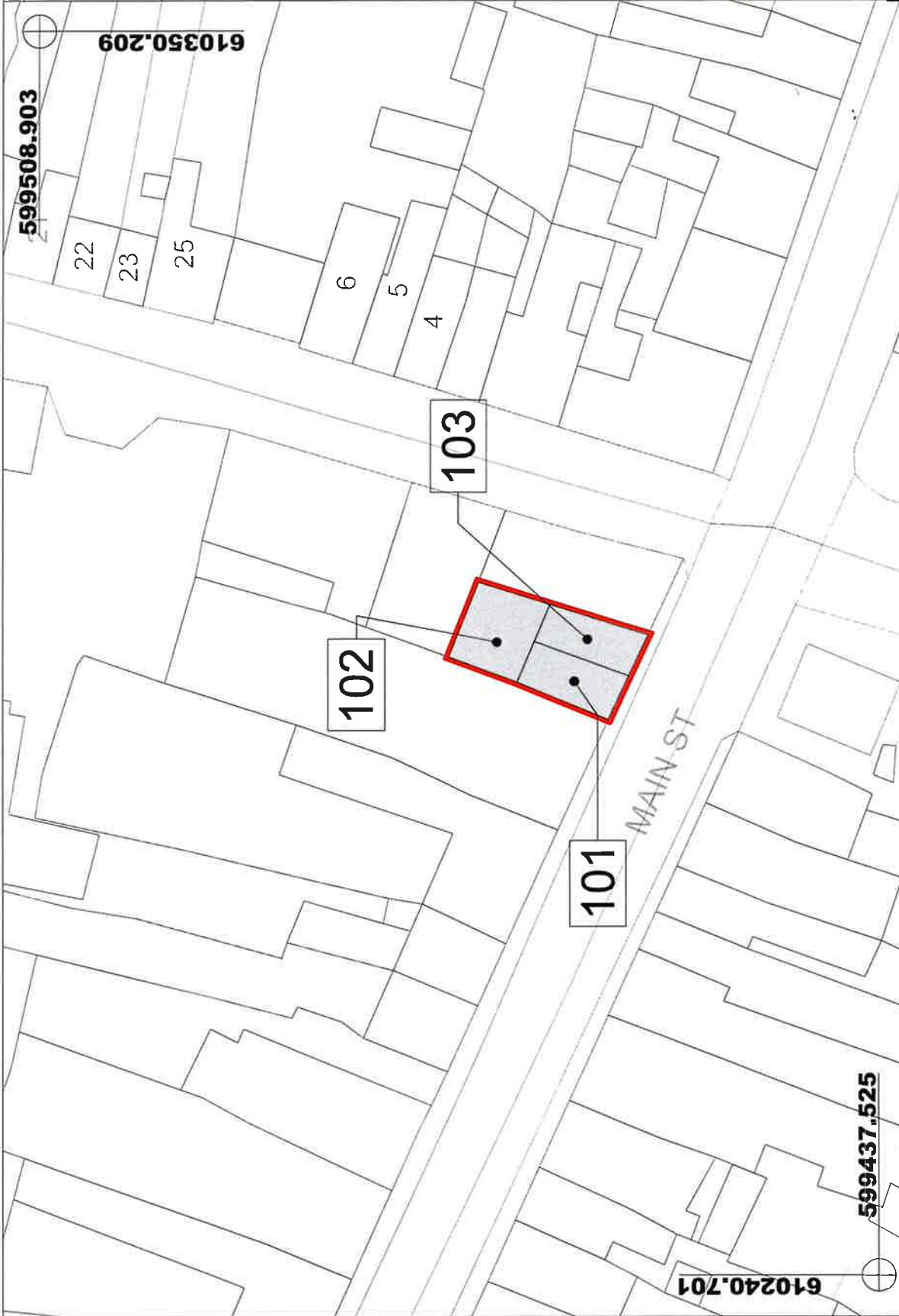

Plot Ref. No. Deposited at the Offices of the Local Authority	Area		Townland	Electoral District Division	Description	Owners or reputed Owners	Lessees or Reputed Lessees	Occupiers
	Hectare	Acre						
101	0.0037	0.009	Cappoquin	Lismore	Residential	Michaek Uniacke	Unknown	Unknown
102	0.005	0.013	Cappoquin	Lismore	Residential	Michaek Uniacke	Unknown	Unknown
103	0.0035	0.009	Cappoquin	Lismore	Residential	Michaek Uniacke	Unknown	Unknown