

Refer to Dwg 11624-LD-PLN-027

Notes  
Do not scale from this drawing.  
All dimensions are drawn in millimetres.  
Drawing & design copyright LUC.  
Reproduction of this drawing in whole or in part is prohibited without prior permission.

- KEY**
- Red Line Boundary
- Hardworks**
- Coloured asphalt: Buff
  - Natural stone setts: Dark Grey
  - Interpretation at threshold
- Edging**
- PCC edging: Grey
  - Steel edging planters (flush)
  - Steel I-Beam detail (inset)

- Boundaries and Restraints**
- Parapet mounted steel fin balustrade and timber handrail: 150mm height
  - Timber post and strained wire fence: 1.2m height

- Site Furniture**
- Timber lighting bollard
  - Metal finger post signage

- Softworks**
- Ornamental planting
  - Wildflower grass seeding

- Existing**
- River Blackwater
  - Key features and buildings
  - Fence line to be retained. Allowance to make good
  - Path in Mill Wheel Park to be retained
  - Wall to be retained
  - Asphalt to be retained. Allowance to make good
  - Concrete surfacing to be retained
  - Vegetation to be retained. Allowance to make good
  - Existing Tree to be retained
  - Existing Tree to be removed

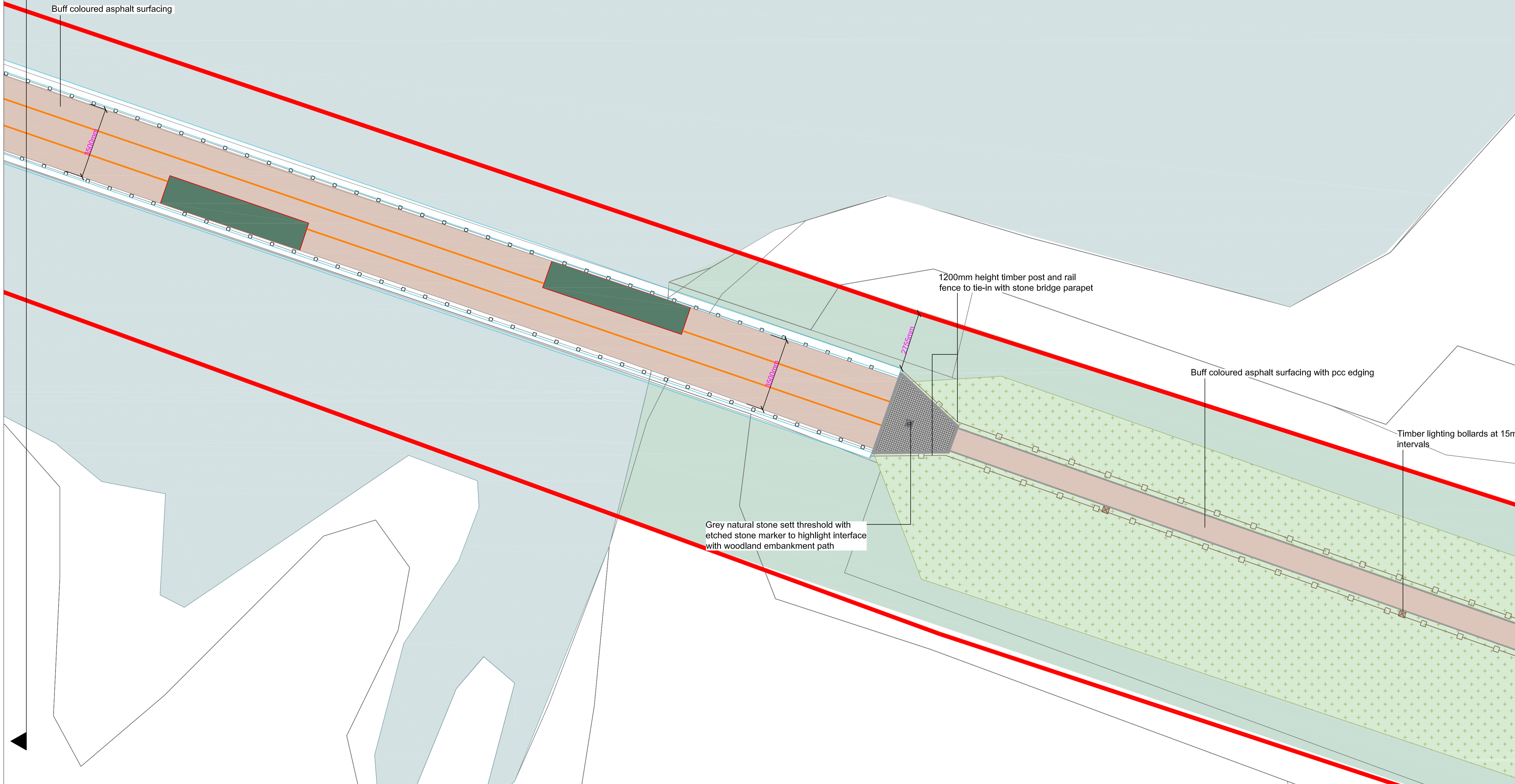
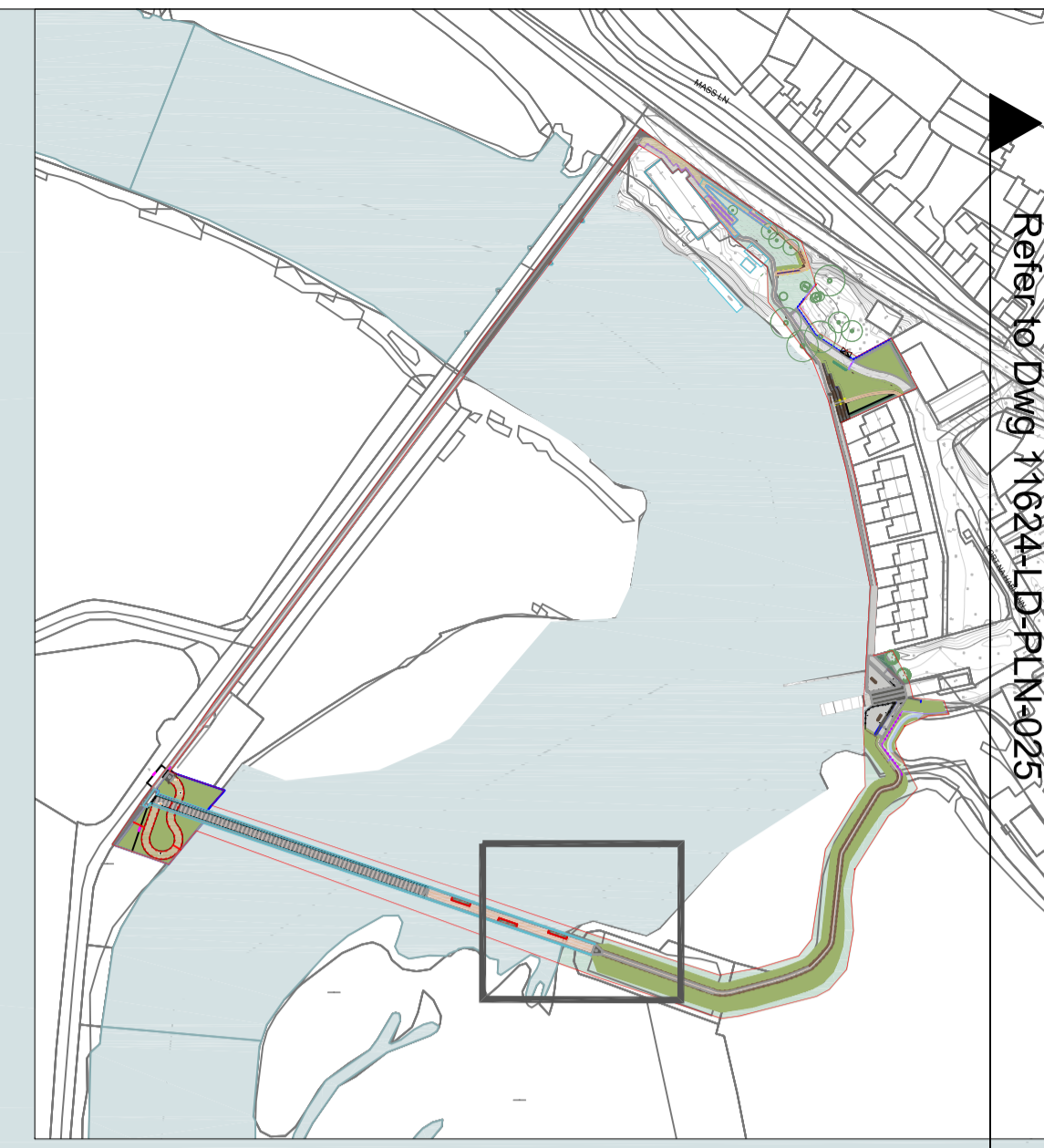

CYAL50233107 © Ordnance Survey Ireland/Government of Ireland

No	Date	Description	DRN	CHK
A	12.05.22	First Issue	AR	TJ

**LUC** LUC Manchester  
6th Flr, 55 King Street, Manchester, M2 4LQ  
+44 (0)161 537 5960  
manchester@landuse.co.uk  
www.landuse.co.uk

Project  
**Cappoquin Amenity Hub Walking Trail**

Client  
Waterford City and County Council

Scale @A1  
1:100

Status  
Planning

Drawing Title  
General Arrangement

Sheet 7

Job Nr 11624	Drawing Nr 11624-LD-PLN-026	Issue A
-----------------	--------------------------------	------------