

Refer to Dwg 11624-LD-PLN-028

Notes  
Do not scale from this drawing.  
All dimensions are drawn in millimetres.  
Drawing & design copyright LUC.  
Reproduction of this drawing in whole or in part is prohibited without prior permission.

- KEY**
- Red Line Boundary
- Hardworks**
- Coloured asphalt: Buff
  - Natural stone setts: Dark Grey
  - Interpretation at threshold
- Edging**
- PCC edging: Grey
  - Steel edging planters (flush)
  - Steel I-Beam detail (inset)

- Boundaries and Restraints**
- Parapet mounted steel fin balustrade and timber handrail: 150mm height
  - Timber post and strained wire fence: 1.2m height

- Site Furniture**
- Timber lighting bollard
  - Metal finger post signage

- Softworks**
- Ornamental planting
  - Wildflower grass seeding

- Existing**
- River Blackwater
  - Key features and buildings
  - Fence line to be retained. Allowance to make good
  - Path in Mill Wheel Park to be retained
  - Wall to be retained
  - Asphalt to be retained. Allowance to make good
  - Concrete surfacing to be retained
  - Vegetation to be retained. Allowance to make good
  - Existing Tree to be retained
  - Existing Tree to be removed

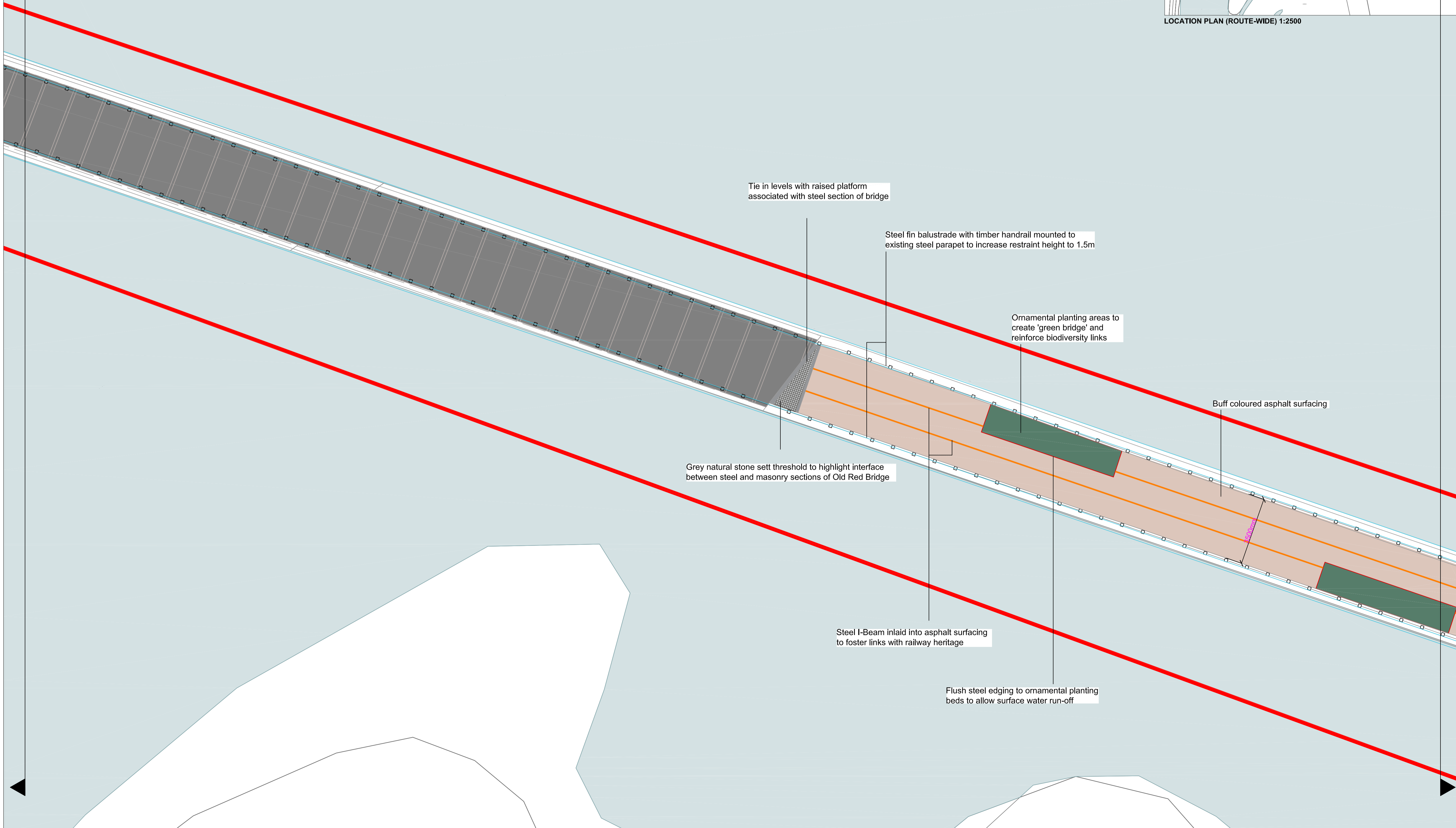
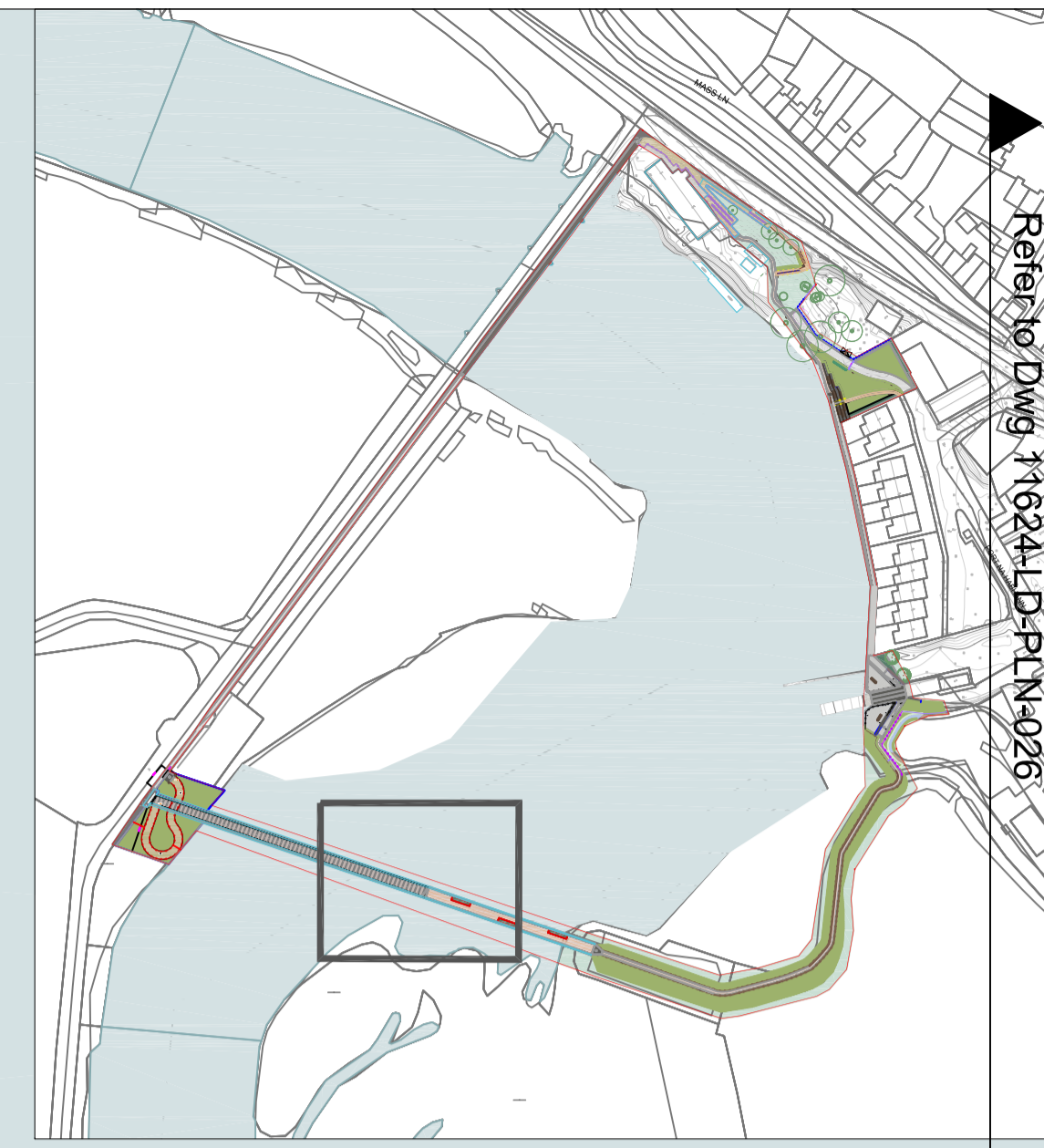

Tie in levels with raised platform associated with steel section of bridge

Steel fin balustrade with timber handrail mounted to existing steel parapet to increase restraint height to 1.5m

Ornamental planting areas to create 'green bridge' and reinforce biodiversity links

Buff coloured asphalt surfacing

Grey natural stone sett threshold to highlight interface between steel and masonry sections of Old Red Bridge

Steel I-Beam inlaid into asphalt surfacing to foster links with railway heritage

Flush steel edging to ornamental planting beds to allow surface water run-off



CYAL50233107 © Ordnance Survey Ireland/Government of Ireland

No.	Date	Description	By	CHK
A	12.05.22	First Issue	AR	TJ

**LUC** LUC Manchester  
6th Flr, 55 King Street, Manchester, M2 4LQ  
+44 (0)161 537 5960  
manchester@lucdusa.co.uk  
www.lucdusa.co.uk

Project <b>Cappoquin Amenity Hub Walking Trail</b>	
Client Waterford City and County Council	
Scale @A1 1:100	Status Planning
Drawing Title General Arrangement Sheet 8	
Job Nr 11624	Drawing Nr 11624-LD-PLN-027
Issue A	