

IMPORTANT: It is the responsibility of the Contractor to check and agree with Frank Fox & Associates all levels, datum and reference points prior to commencement of contract. This drawing shall not be altered or copied without the consent of Frank Fox & Associates.

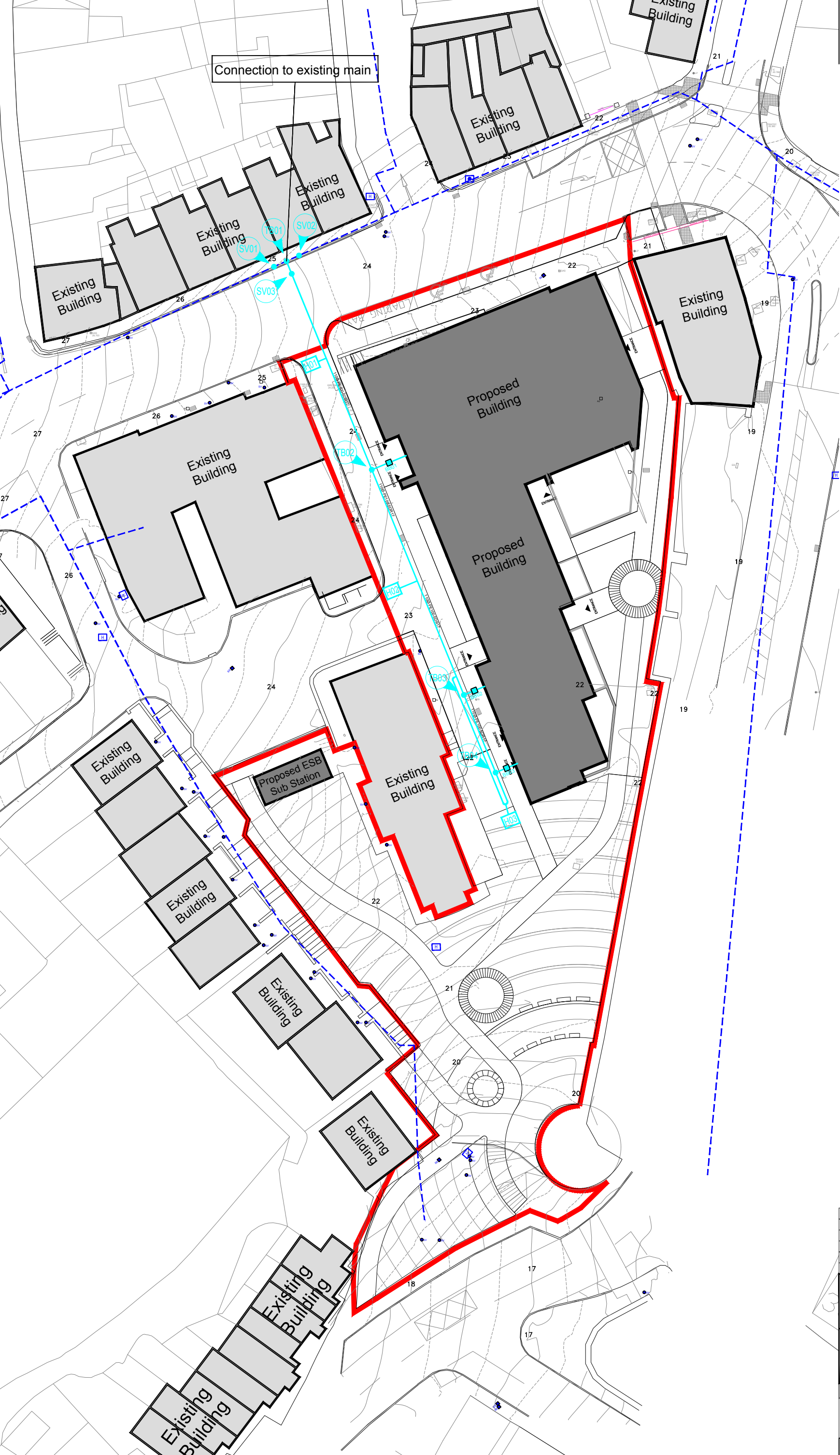

NOTES:
 This drawing is not to be scaled:
 Figured dimensions only are to be taken from this drawing.
 All setting out dimensions are to be checked and confirmed on site prior to commencement of work.
 Any discrepancies encountered to be brought to the attention of Frank Fox & Associates without delay.
IF IN DOUBT ASK.

Levels to OD Main Head.
 Road elevations and levels on this drawing are rounded. For uses to road sign see printouts.

KEY

- New Water mains**
 All Water Mains to be PE100 SDR 17 Polyethylene.
 All House Water Connections to be PE80 SDR 11.
 All Water Infrastructure to be installed as Per Irish Water's Standard Details.
 All Water Systems to be installed as Per Irish Water's Water Infrastructure Connections & Developer Services: IW205-5020-03.
 All Services to be installed as Per Irish Water's Water Separation Distances as Per Drawing STD-W-11 Rev. 2
- Existing Watermain** [Blue dashed line symbol]
- Watermain**
 PE100 1100 unless otherwise noted [Red solid line symbol]
- Boundary Box**
 as per Irish Water Standard
 Detail Drawing STD-W-03 Rev.4 [Blue square symbol]
- Fire hydrant**
 with thrust block (off line) as per Irish Water Standard Detail Drawing STD-W-19 Rev.4 [Blue circle with cross symbol]
- New Fire hydrant**
 with thrust block (on line) as per Irish Water Standard Detail Drawing STD-W-18 Rev.3 [Blue circle with cross symbol]
- New Fire hydrant**
 with thrust block (Washout) as per Irish Water Standard Detail Drawing STD-W-30A Rev.2
 All Fire Hydrant to be Located in [Blue circle with cross symbol]
- New Scour valve**
 with Wash Out Hydrant as per Irish Water Standard Detail Drawing STD-W-30A Rev.3 [Blue circle with cross symbol]
- Sluice valve**
 as per Irish Water Standard
 Detail Drawing STD-W-14 Rev.4 [Blue circle with cross symbol]
- Air Valve**
 as per Irish Water Standard
 Detail Drawing STD-W-22 Rev.3 [Blue circle with cross symbol]
- Trust Block**
 as per Irish Water Standard
 Detail Drawing STD-W-28 Rev.1 [Blue circle with cross symbol]
- Bulk Meter Chamber** [Blue circle with cross symbol]
- Connection Point** [Blue circle with cross symbol]
- Pipe Weld Location** [Blue circle with cross symbol]
- Tapping Tee Piece** [Blue circle with cross symbol]
- Site Boundary** [Red solid line symbol]

Wednesday 1st DECEMBER 2021
PLANNING ONLY
 THIS DRAWING IS NOT TO BE USED
 FOR CONSTRUCTION PURPOSES

REV	DESCRIPTION	BY	DATE
PROJECT TITLE			
WATERFORD COUNCIL. APARTMENTS NEW GATE STREET. WATERFORD.			
DWG TITLE			
WATERMAIN PLAN			
DRAWN	CHECKED	DATE	SCALES
T. Downey	Robert Fox	11.11.2021	1:200
FRANK FOX & ASSOCIATES <small>CIVIL & STRUCTURAL CONSULTING ENGINEERS 7 BANK LANE WATERFORD, IRELAND TEL 353-51-872799 Fax 353-51-876626 Email design@ffaceng.com</small>			
PROJECT No.	DWG No	REV	
221014	WP/01		