

Section 38 - Road Traffic Act, 1994

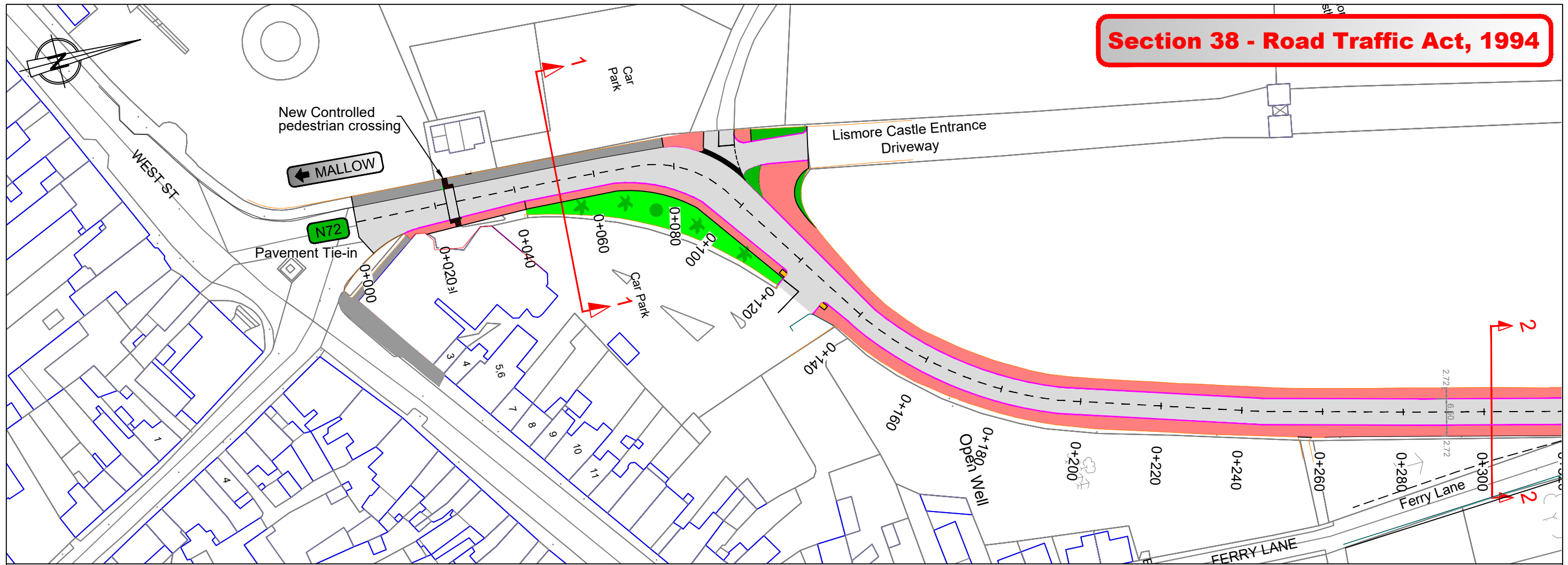

CROSS SECTION 1-1
N72 Proposed Cross Section

Scale 1:100

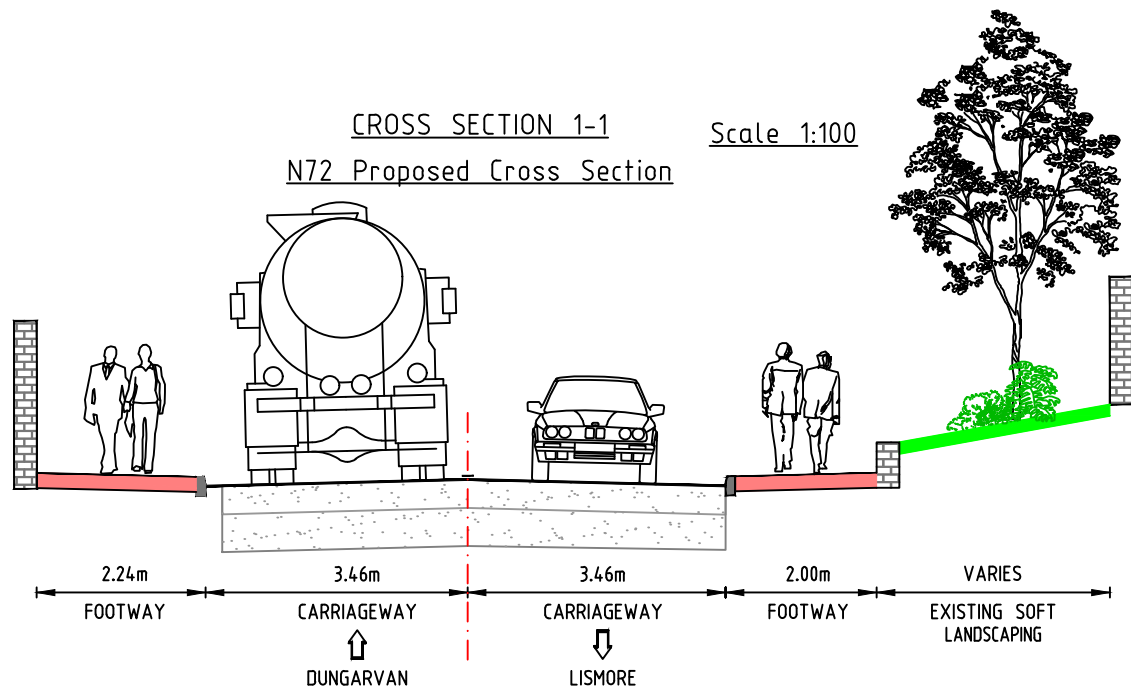

CROSS SECTION 2-2
N72 Proposed Cross Section

Scale 1:100

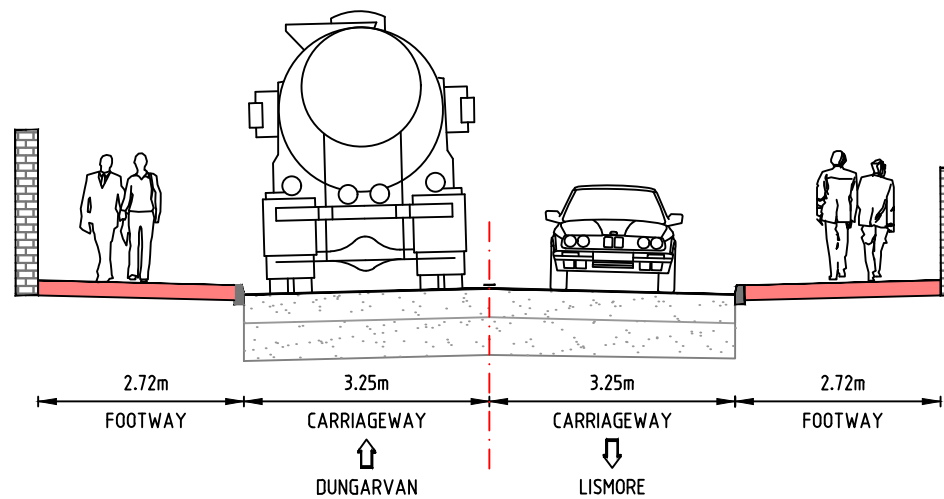

Note:
The proposed traffic calming measures are subject to change further to a Road Safety Audit and to a Detailed Design process.

- LEGEND:
- Existing footpath
 - Existing landscape area
 - New kerbline
 - Pavement resurfacing
 - New footpath
 - New landscape area

NOTES:
DO NOT SCALE

Revision	Date	Description	Drawn by	Checked by	Approved by
R1	27/05/2022	Drawing issued for Section 38 - Road Traffic Act, 1994	CH	JS / BE	JS

Client:



Design:



Approved by: G. Hynes (GH)
Checked by: J. Scully (JS) / B. Erak (BE)
Drawn by: C. Horgan (CH)
Scale: 1:1000 (@A3)
Rev. Date: 27/05/2022

Project Title: N72 Lismore Traffic Calming Scheme - Phase 1
Drawing Title: Proposed Layout Southern Section
Drawing Number: MRG-6-22-003 - DWG-501

TII Project No.: ---
MRG Project No.: MRG-6_22_003
Project Folder No.: 02
Rev.: R1

Unauthorised reproduction infringes Ordnance Survey Ireland and Government of Ireland copyright.