

MWP

South East Greenway
EIA Screening Report

Waterford City and County Council

June 2021

Contents

1.	Introduction	1
2.	Overview	1
3.	Change of Impact	2
3.1	Transfrontier Nature of the Impact	2
3.2	Air Quality and Climate	2
3.3	Noise and Vibration	2
3.4	Human Beings	2
3.5	Ecology	3
3.6	Soils and Geology	3
3.7	Hydrogeology	3
3.8	Landscape and Visual	3
3.9	Archaeology, Architecture and Cultural Heritage	3
3.10	Socio-economic	3
3.11	Resource and Waste Management	4
3.12	Interactions	4
4.	Conclusion	4

Project No.	Doc. No.	Rev.	Date	Prepared By	Checked By	Approved By	Status
19983	XX01-MWP-ZZ-ZZ-HS-Z-6051-A	A	08.06.2021	JOL	SB	JOL	Client Issue

MWP, Engineering and Environmental Consultants
Address: Reen Point, Blennerville, Tralee, Co. Kerry
www.mwp.ie



1. Introduction

An EIA Screening Report was carried out in December 2016 by Roughan & O Donovan, Consulting Engineers, for the then proposed Waterford to New Ross Greenway. This ROD report confirmed that an EIA was not required for the proposed development.

This current review and update of the ROD EIA Screening Report has been prepared by Malachy Walsh and Partners (MWP) to support a planning application for an access ramp and ancillary length of greenway adjacent to Abbey Road, Waterford. The EIA Screening is supported by an AA Screening, also prepared by MWP for the planning application.

2. Overview

The conclusion of the ROD EIA Screening is shown in Fig 1.

6. CONCLUSION

6.1 Introduction
This screening report has been carried out in accordance with a methodology that is based on *Environmental Impact Assessment (EIA), Guidance for Consent Authorities regarding Sub-threshold Development (DEHLG, 2003)*, *Environmental Impact Assessment of National Road Schemes – A Practical Guide (NRA, 2008)* and *The European Commission Guidelines on EIA Screening (June 2001)*.

6.2 Mandatory EIA
The proposed Waterford to New Ross Cycleway & Walkway does not exceed any of the thresholds outlined in the Roads Act 1993, as amended, that would trigger a mandatory requirement to prepare an EIS.

6.3 Sub-Threshold EIA
The proposed development is sub-threshold and therefore is assessed in accordance with Article 27 of the European Communities (EIA) Regulations, 1989.

7. CONCLUSION AND RECOMMENDATIONS
Under Section 50 (1) (c) of the Roads Act, 1993 Kilkenny County Council considers that the proposed Greenway development does not have potential to have significant effects on the environment for those reasons listed in the previous sections and, as such, it is not recommended that an EIS is required.

Fig 1 Conclusion of ROD EIA Screening

This conclusion confirmed that an EIA was not required. MWP, using the same assessment criteria as ROD, have reviewed the potential for any change of impact arising the works now anticipated at Abbey Road. These are reviewed in Section 3. The Abbey Road works are shown on Fig 2.

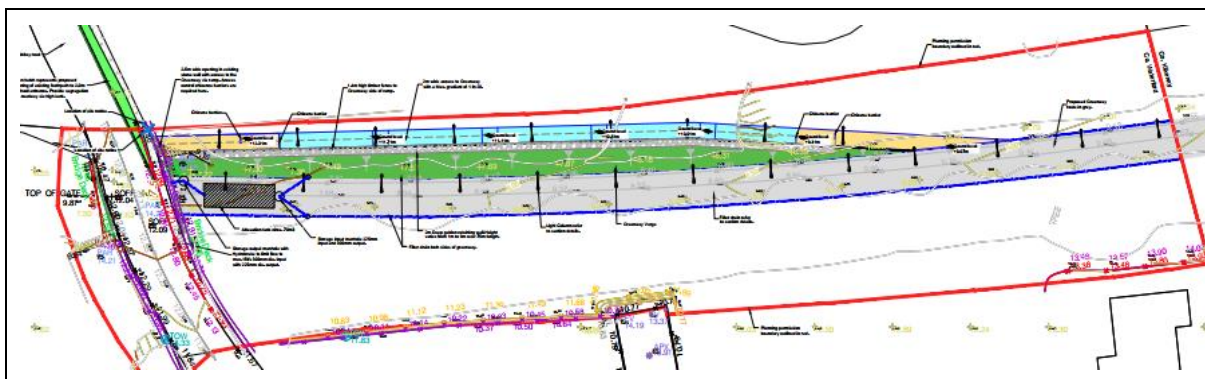

Fig 2 Abbey Road Works

3. Change of Impact

3.1 Transfrontier Nature of the Impact

No change.

3.2 Air Quality and Climate

No change.

3.3 Noise and Vibration

No change

3.4 Human Beings

No change

3.5 Ecology

No change. This is supported by an AA Screening.

3.6 Soils and Geology

No change

3.7 Hydrogeology

No change

3.8 Landscape and Visual

No change

3.9 Archaeology, Architecture and Cultural Heritage

No change

3.10 Socio-economic

No change

3.11 Resource and Waste Management

No change

3.12 Interactions

No change

4. Conclusion

This review and update of the ROD EIA screening has been prepared by Malachy Walsh and Partners (MWP) to support a planning application for an access ramp and ancillary length of greenway adjacent to Abbey Road, Waterford. The EIA Screening is supported by an AA Screening, also prepared by MWP, for the planning application. The review confirms that an EIA is not required for the works.