

DO NOT SCALE FROM THIS DRAWING. USE FOURED DIMENSIONING IN ALL CASES.
 VERIFY ALL DIMENSIONS AND LEVELS WITH THE ARCHITECT'S ORIGINAL SET.
 THIS DRAWING IS TO BE READ IN CONJUNCTION WITH THE ARCHITECT'S SPECIFICATION.
 © THIS DRAWING IS COPYRIGHT AND MAY ONLY BE REPRODUCED WITH THE ARCHITECT'S PERMISSION.

LEGEND:

- SITE BOUNDARY
SHOWN AS —
- EXISTING DWELLING
For Future Development
SHOWN AS —
- PROPOSED BUILDING – 14 NO. APARTMENTS.
SHOWN AS ■
- PROPOSED SWITCH ROOM & BIN STORE.
SHOWN AS ■
- PROPOSED PUBLIC OPEN SPACE
SHOWN AS ■
- EXISTING SITE SPOT LEVELS
SHOWN AS — 88.326
- PROPOSED SITE SPOT LEVELS
SHOWN AS — +88.326
- LOCATION OF SITE NOTICE
SHOWN AS ✱

NOTE: TO ENGINEERS DRAWINGS FOR Foul AND SURFACE WATER DRAINAGE LAYOUTS.

NOTE: REFER TO ENGINEERS DRAWINGS FOR MAINS WATER CONNECTION

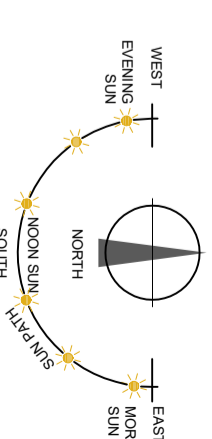

OS DATUM - LEVELS RELATE TO ORDNANCE SURVEY DATUM (MALIN HEAD)
 Ordnance Survey Ireland Licence No. AR00005419 @ Government of Ireland
 Map Ref. No. 5702-06

REV	DATE	DRAWN	NOTES

CJFA ARCHITECTS
C.J. Falconer + Associates
 ARCHITECTS

St. Patrick's House, Newtown, Waterford, Ireland. X91-FR76
 t: +353 (0)51 878888 f: +353 (0)51 878794 e: mail@cjfa.ie w: www.cjfa.ie

JOB NUMBER: 2019026	DWG. SERIES: Part 8 Submission	STATUS CODE: S1
-------------------------------	--	---------------------------

CLIENT: Waterford City & County Council
 JOB: Social Housing Development at Mount Esker, Inner Ring Road, Co. Waterford.

DATE: 17.02.2020	SCALE: A3 - 1:250
DRAWN: DAVID DEVINE	CHECKED: GARY FALCONER

PROJECT: BTR	ORIGINATOR: CJFA	ZONE: 00	LEVEL: ZZ	TYPE: DR	DISC: A	NUMBER: 0102	REVISION:
--------------	------------------	----------	-----------	----------	---------	--------------	-----------

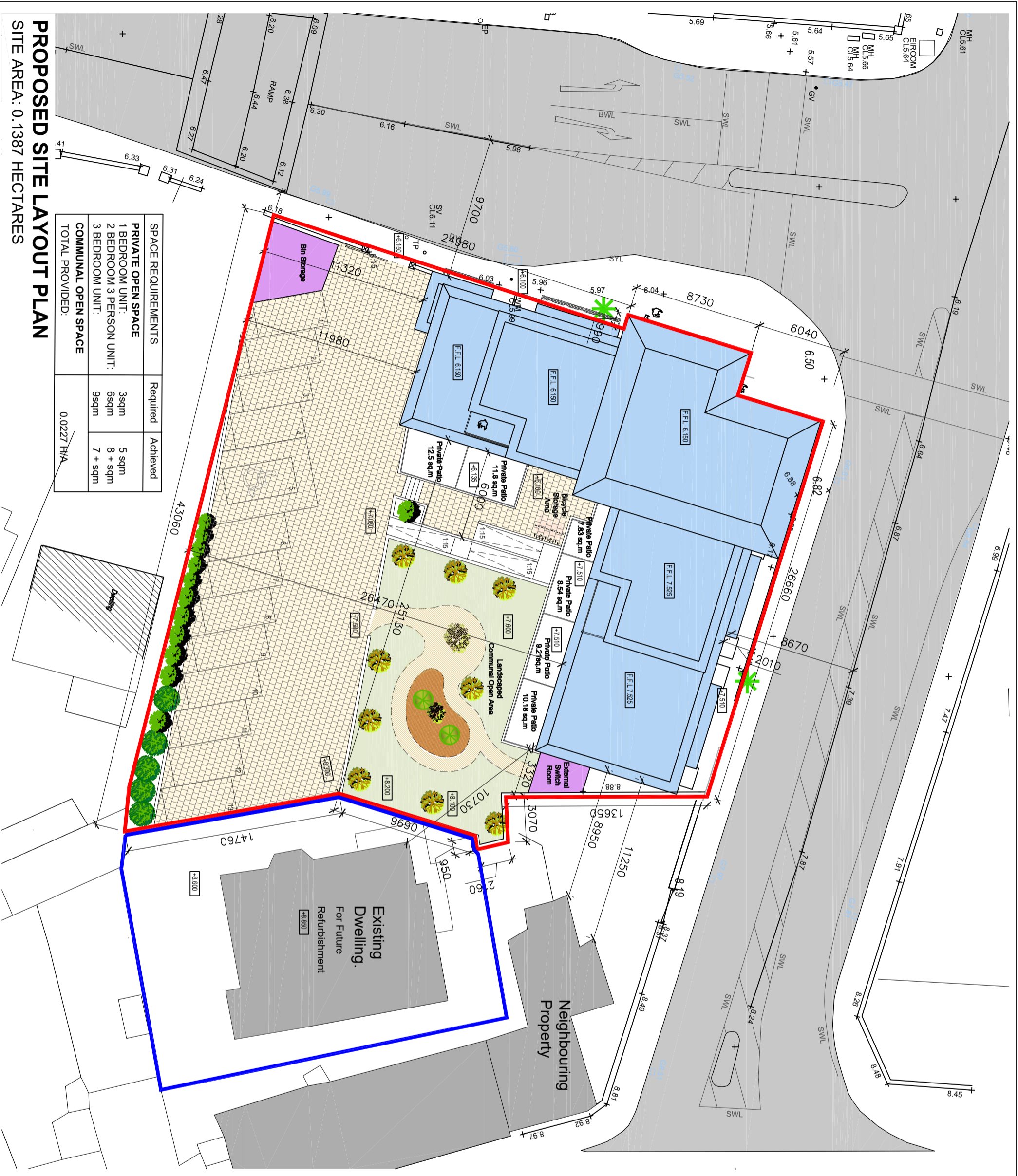

SPACE REQUIREMENTS	Required	Achieved
PRIVATE OPEN SPACE		
1 BEDROOM UNIT:	3sqm	5 sqm
2 BEDROOM 3 PERSON UNIT:	6sqm	8 + sqm
3 BEDROOM UNIT:	9sqm	7 + sqm
COMMUNAL OPEN SPACE		
TOTAL PROVIDED:	0.0227 HA	

PROPOSED SITE LAYOUT PLAN
 SITE AREA: 0.1387 HECTARES