

Ground Floor Plan
Scale 1:100

Outline Specification

- East Courtyard screen
- Existing earched door openings to be infilled with 150mm insulated timber stud partition.
- Existing garage doors to be retained on outside face. Internal face to have marine plywood lining for fire-ou by specialist.
- New concrete floor on 150mm insulation, tile finish.
- Ventilation to proprietary/roof mounted extract units
- Accessible WC to have Doc M fit-out complete

Escape stairs and platform III:

- New stairs to have steel formed carcass overlaid with hardwood heads and risers, soffit to be plastered for paint finish.
- Beige platform fit with clear glazed guarding to be structurally independent of the staircase.

Fit floor tables:

- Sanitary ware to be set out along party wall with rear void for maintenance access.
- Ventilyl units/bathrooms to complete free-standing island units
- American Stonic fittings or equivalent
- fit proprietary catchle system or equivalent
- Accessible WC to have Doc M fit-out complete

New door to north terrace:
Solid timber, raised and beaded panel door, paint finish.

Basement Floor Plan
Scale 1:100

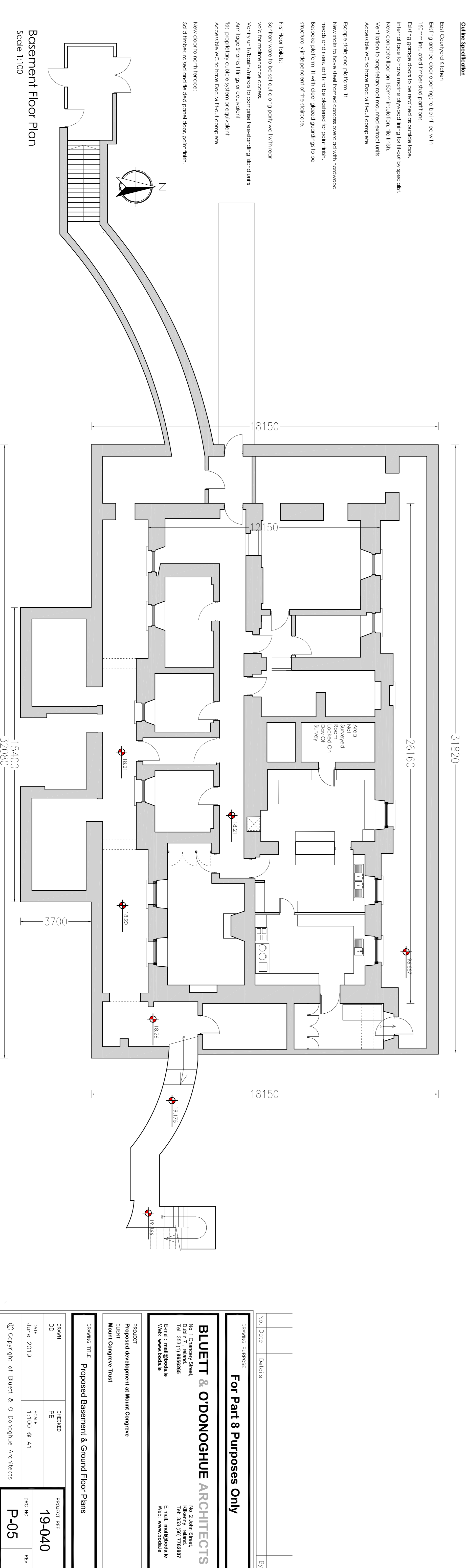

No. Date Details

By

Checked

Drawn

Project Reference

For Part 8 Purposes Only

BLUETT & O'DONOGHUE ARCHITECTS

No. 1, Clarendon Street,
Dunedin,
Tel: 353 (0) 865665
Email: enquiries@bluett.co.nz
Web: www.bluett.co.nz

No. 2, John Street,
Dunedin,
Tel: 353 (0) 772907
Email: enquiries@odonoghue.co.nz
Web: www.odonoghue.co.nz

PROJECT
Proposed development at Mount Congreve

CLIENT
Mount Congreve Trust

DRAWING TITLE
Proposed Basement & Ground Floor Plans

PROJECT REF	19-040
DATE	June 2019
SCALE	1:100 @ A1
DWG NO	P-05
REV	

© Copyright of Bluett & O'Donoghue Architects